

Линия совмещения с листом 3

Линия совмещения с листом 6

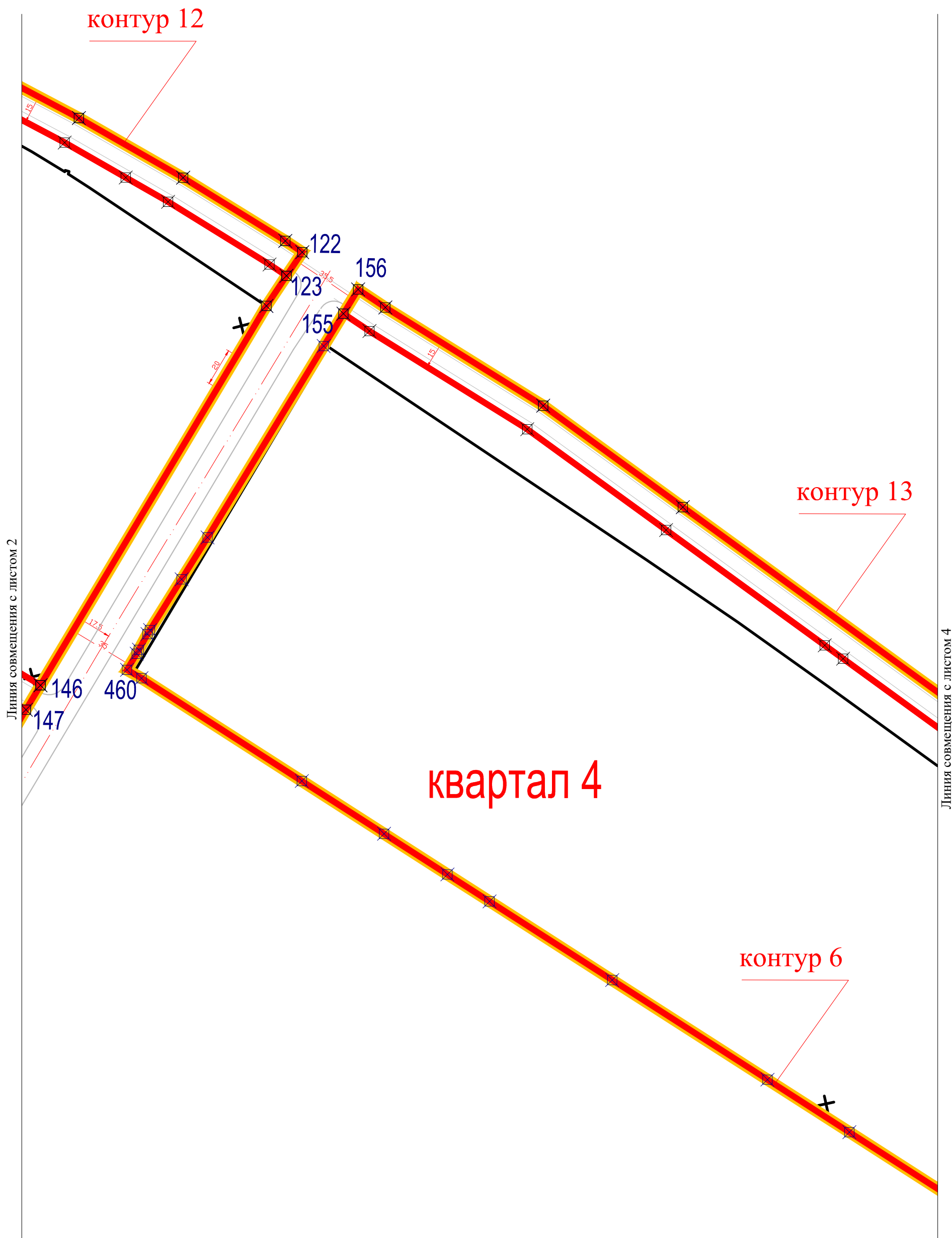

Линия совмещения с листом 3

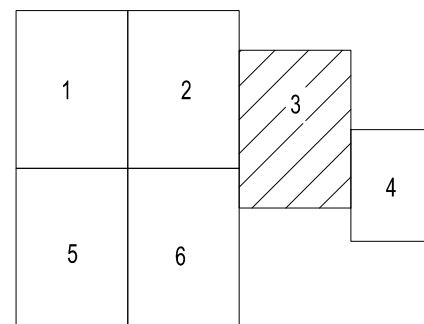
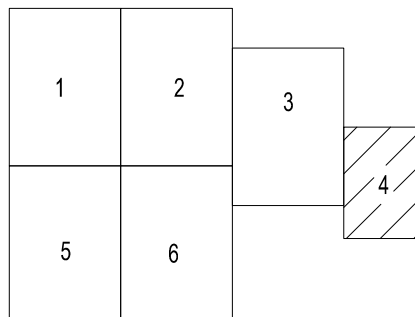
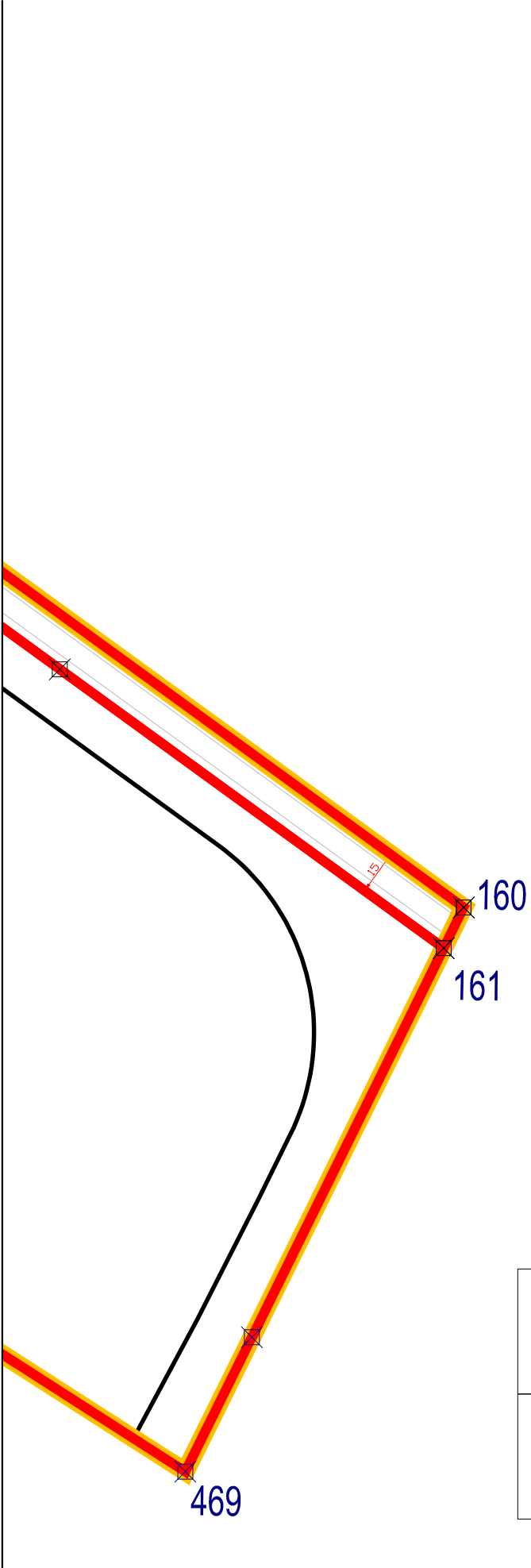

Линия совмещения с листом 1

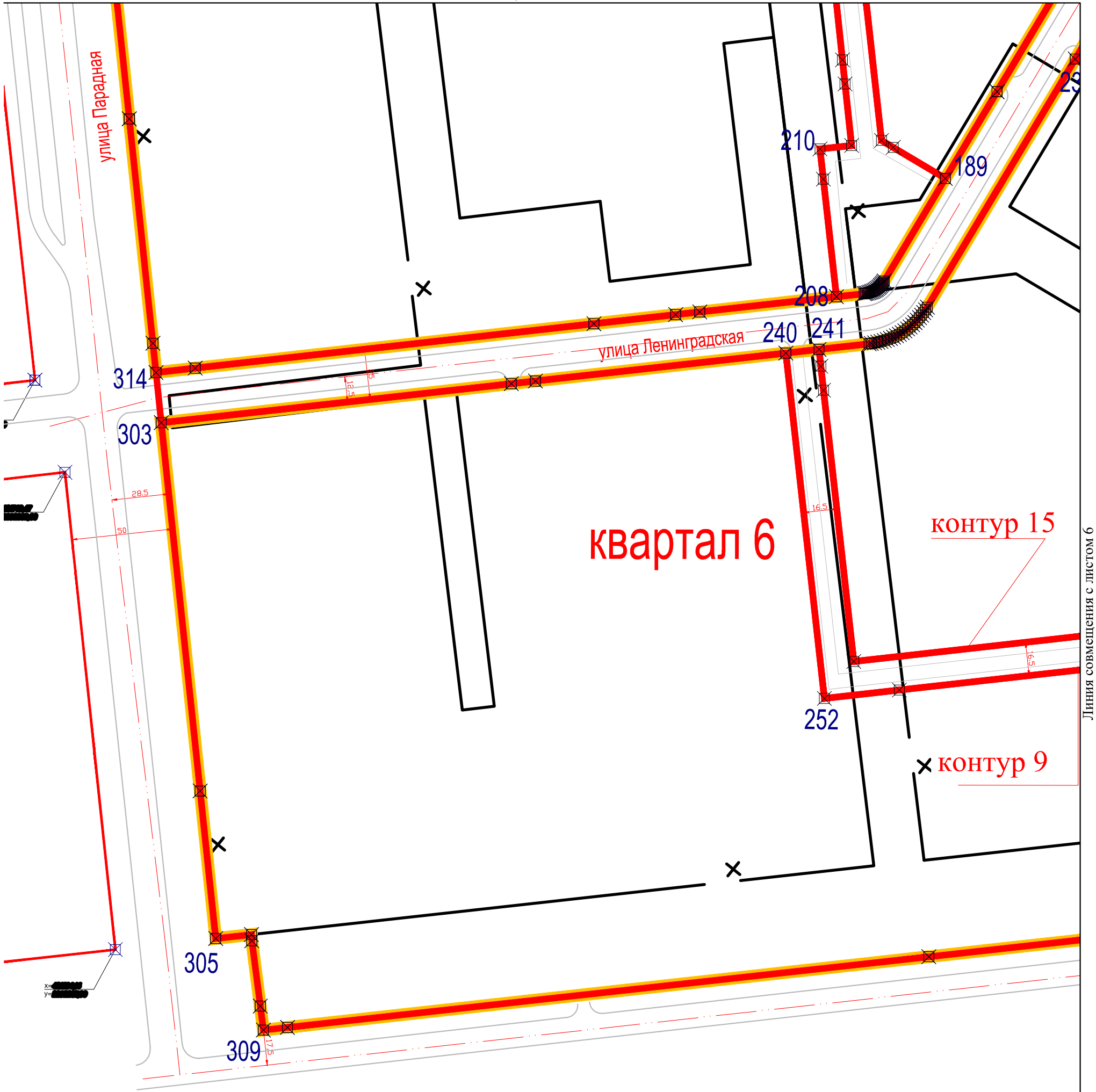

Линия совмещения с листом 6

Схема совмещения листов

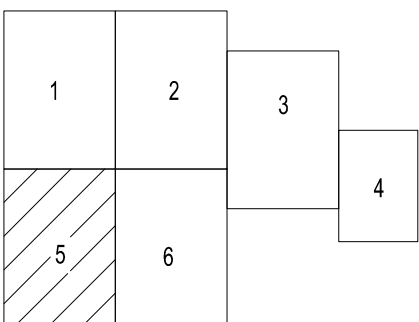

Линия совмещения с листом 2



Схема совмещения листов



Приложение к чертежу планировки территории, отображающему красные линии, границы планируемого элемента планировочной структуры

**Перечень координат  
характерных точек устанавливаемых красных линий**

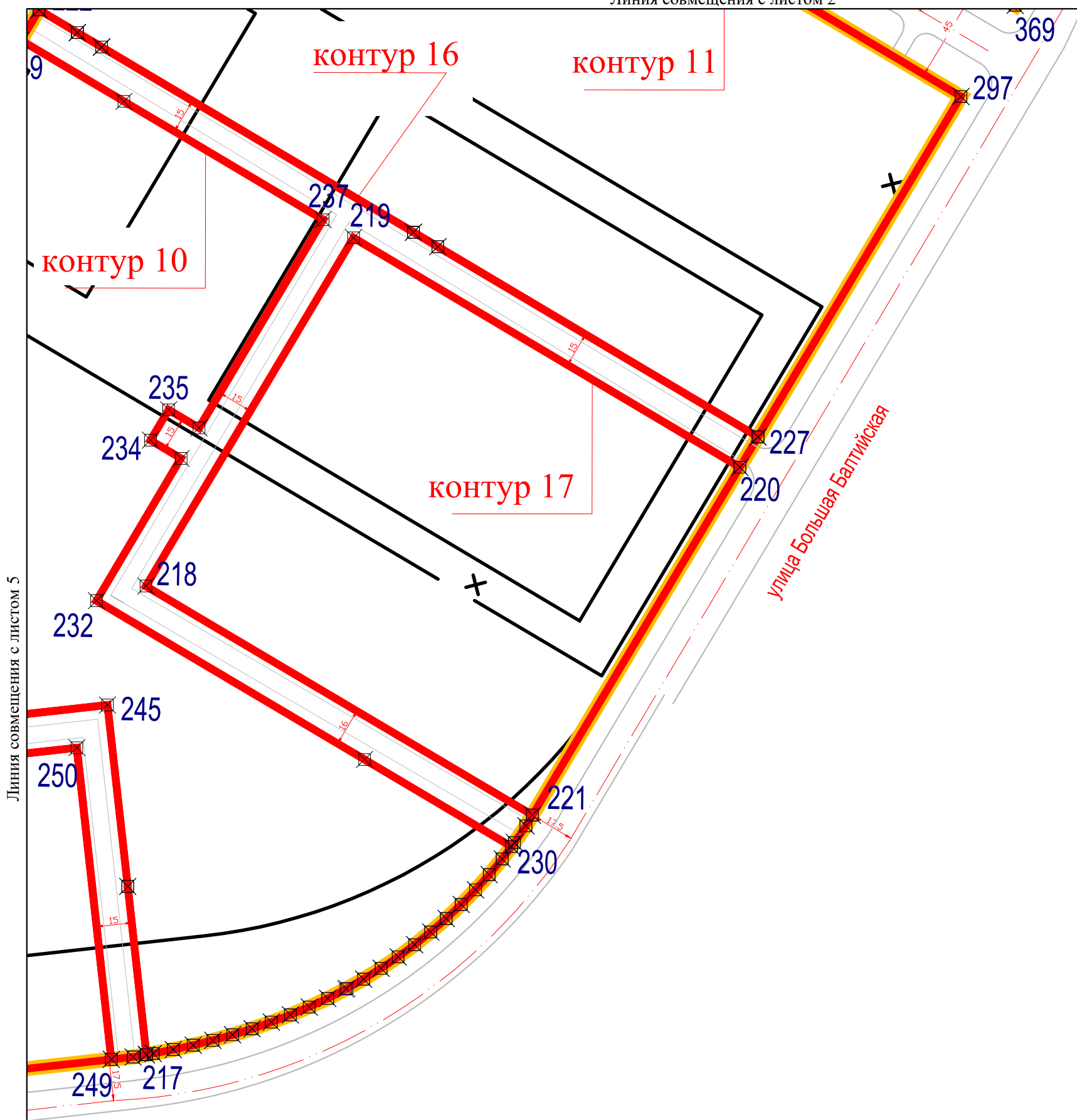
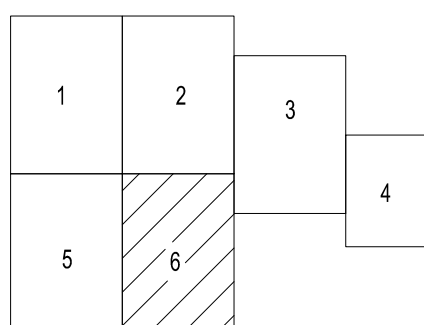
Квартал 1

| №№<br>пун-кта | Дирекционный угол | Длина<br>линии, м | X          | Y            |
|---------------|-------------------|-------------------|------------|--------------|
| 1             | 68° 51' 52"       | 11,30             | 422 559,41 | 2 202 587,60 |
| 2             | 65° 28' 51"       | 12,70             | 422 563,50 | 2 202 598,18 |
| 3             | 62° 27' 55"       | 12,20             | 422 568,75 | 2 202 609,69 |
| 4             | 59° 52' 15"       | 11,70             | 422 574,37 | 2 202 620,47 |
| 5             | 57° 33' 40"       | 13,60             | 422 580,22 | 2 202 630,55 |
| 6             | 55° 34' 2"        | 12,80             | 422 587,51 | 2 202 642,02 |
| 7             | 54° 16' 31"       | 12,10             | 422 594,77 | 2 202 652,61 |
| 8             | 53° 36' 48"       | 11,40             | 422 601,84 | 2 202 662,44 |
| 9             | 53° 29' 15"       | 41,70             | 422 608,59 | 2 202 671,60 |
| 10            | 52° 41' 3"        | 11,10             | 422 633,39 | 2 202 705,10 |
| 11            | 53° 22' 40"       | 9,70              | 422 640,09 | 2 202 713,89 |
| 12            | 55° 12' 37"       | 11,10             | 422 645,88 | 2 202 721,68 |
| 13            | 58° 25' 51"       | 9,70              | 422 652,23 | 2 202 730,82 |
| 14            | 62° 0' 32"        | 8,30              | 422 657,33 | 2 202 739,12 |
| 15            | 68° 14' 55"       | 8,50              | 422 661,21 | 2 202 746,42 |
| 16            | 75° 23' 51"       | 3,90              | 422 664,35 | 2 202 754,29 |
| 17            | 79° 51' 54"       | 3,90              | 422 665,34 | 2 202 758,09 |
| 18            | 100° 2' 47"       | 7,70              | 422 666,03 | 2 202 761,95 |

|    |              |       |            |              |
|----|--------------|-------|------------|--------------|
| 19 | 100° 16' 21" | 17,40 | 422 664,68 | 2 202 769,57 |
| 20 | 100° 57' 9"  | 11,60 | 422 661,57 | 2 202 786,73 |
| 21 | 101° 13' 7"  | 13,60 | 422 659,36 | 2 202 798,15 |
| 22 | 101° 28' 42" | 15,30 | 422 656,72 | 2 202 811,46 |
| 23 | 102° 44' 43" | 4,30  | 422 653,67 | 2 202 826,48 |
| 24 | 102° 20' 10" | 6,50  | 422 652,72 | 2 202 830,68 |
| 25 | 102° 17' 41" | 17,80 | 422 651,34 | 2 202 836,99 |
| 26 | 103° 7' 53"  | 28,60 | 422 647,55 | 2 202 854,38 |
| 27 | 104° 0' 7"   | 28,60 | 422 641,06 | 2 202 882,20 |
| 28 | 104° 50' 55" | 28,60 | 422 634,15 | 2 202 909,91 |
| 29 | 105° 44' 39" | 28,60 | 422 626,83 | 2 202 937,52 |
| 30 | 106° 35' 43" | 28,60 | 422 619,08 | 2 202 965,01 |
| 31 | 107° 24' 49" | 28,60 | 422 610,92 | 2 202 992,39 |
| 32 | 108° 16' 57" | 28,60 | 422 602,37 | 2 203 019,65 |
| 33 | 109° 8' 42"  | 28,60 | 422 593,41 | 2 203 046,77 |
| 34 | 110° 44' 40" | 41,30 | 422 584,04 | 2 203 073,76 |
| 35 | 112° 17' 35" | 47,60 | 422 569,42 | 2 203 112,36 |
| 36 | 113° 57' 11" | 63,50 | 422 551,36 | 2 203 156,41 |
| 37 | 115° 53' 33" | 42,30 | 422 525,58 | 2 203 214,44 |
| 38 | 289° 27' 30" | 12,00 | 422 507,11 | 2 203 252,49 |
| 39 | 287° 34' 37" | 12,30 | 422 511,12 | 2 203 241,14 |
| 40 | 287° 33' 47" | 12,30 | 422 514,82 | 2 203 229,46 |
| 41 | 287° 36' 27" | 12,30 | 422 518,52 | 2 203 217,77 |
| 42 | 287° 33' 47" | 12,30 | 422 522,23 | 2 203 206,08 |
| 43 | 287° 34' 45" | 12,30 | 422 525,93 | 2 203 194,39 |
| 44 | 286° 41' 8"  | 12,20 | 422 529,64 | 2 203 182,68 |
| 45 | 283° 56' 0"  | 12,20 | 422 533,15 | 2 203 170,97 |

|    |              |       |            |              |
|----|--------------|-------|------------|--------------|
| 46 | 283° 51' 29" | 10,10 | 422 536,08 | 2 203 159,16 |
| 47 | 282° 51' 38" | 12,20 | 422 538,51 | 2 203 149,31 |
| 48 | 281° 42' 30" | 12,10 | 422 541,22 | 2 203 137,44 |
| 49 | 280° 33' 31" | 12,10 | 422 543,68 | 2 203 125,57 |
| 50 | 279° 24' 56" | 12,10 | 422 545,90 | 2 203 113,66 |
| 51 | 278° 19' 28" | 12,10 | 422 547,88 | 2 203 101,72 |
| 52 | 276° 53' 23" | 12,10 | 422 549,63 | 2 203 089,76 |
| 53 | 276° 20' 5"  | 12,10 | 422 551,08 | 2 203 077,76 |
| 54 | 274° 54' 21" | 12,00 | 422 552,41 | 2 203 065,78 |
| 55 | 273° 56' 36" | 12,10 | 422 553,44 | 2 203 053,78 |
| 56 | 272° 11' 29" | 12,00 | 422 554,27 | 2 203 041,74 |
| 57 | 271° 51' 35" | 12,00 | 422 554,73 | 2 203 029,72 |
| 58 | 270° 25' 41" | 12,00 | 422 555,12 | 2 203 017,71 |
| 59 | 269° 15' 6"  | 12,30 | 422 555,21 | 2 203 005,67 |
| 60 | 268° 8' 57"  | 11,80 | 422 555,05 | 2 202 993,42 |
| 61 | 266° 33' 28" | 12,00 | 422 554,67 | 2 202 981,66 |
| 62 | 265° 50' 34" | 12,00 | 422 553,95 | 2 202 969,69 |
| 63 | 265° 22' 15" | 12,00 | 422 553,08 | 2 202 957,72 |
| 64 | 264° 11' 59" | 67,60 | 422 552,11 | 2 202 945,74 |
| 65 | 264° 15' 39" | 30,00 | 422 545,28 | 2 202 878,50 |
| 66 | 353° 55' 11" | 26,50 | 422 542,28 | 2 202 848,65 |
| 67 | 263° 53' 17" | 85,00 | 422 568,66 | 2 202 845,84 |
| 68 | 173° 53' 9"  | 26,00 | 422 559,61 | 2 202 761,32 |
| 69 | 282° 6' 26"  | 28,70 | 422 533,75 | 2 202 764,09 |
| 70 | 276° 33' 50" | 99,50 | 422 539,78 | 2 202 735,98 |
| 71 | 279° 27' 37" | 50,30 | 422 551,15 | 2 202 637,17 |

Площадь 37 350 кв. м

## Квартал 2

| <b>№№<br/>пун-кта</b> | <b>Дирекционный угол</b> | <b>Длина<br/>линии, м</b> | <b>X</b>   | <b>Y</b>     |
|-----------------------|--------------------------|---------------------------|------------|--------------|
| 1                     | 108° 45' 40"             | 3,90                      | 422 466,51 | 2 202 289,51 |
| 2                     | 107° 51' 32"             | 6,30                      | 422 465,26 | 2 202 293,19 |
| 3                     | 106° 28' 54"             | 6,30                      | 422 463,33 | 2 202 299,18 |
| 4                     | 104° 33' 49"             | 6,30                      | 422 461,54 | 2 202 305,23 |
| 5                     | 102° 4' 18"              | 6,90                      | 422 459,95 | 2 202 311,35 |
| 6                     | 99° 23' 48"              | 5,80                      | 422 458,50 | 2 202 318,13 |
| 7                     | 96° 18' 37"              | 6,40                      | 422 457,56 | 2 202 323,81 |
| 8                     | 93° 23' 46"              | 3,40                      | 422 456,86 | 2 202 330,14 |
| 9                     | 183° 38' 12"             | 2,40                      | 422 456,66 | 2 202 333,51 |
| 10                    | 91° 22' 44"              | 5,40                      | 422 454,30 | 2 202 333,36 |
| 11                    | 88° 54' 26"              | 3,70                      | 422 454,17 | 2 202 338,76 |
| 12                    | 87° 28' 34"              | 3,60                      | 422 454,24 | 2 202 342,43 |
| 13                    | 85° 26' 31"              | 7,20                      | 422 454,40 | 2 202 346,06 |
| 14                    | 83° 40' 39"              | 3,50                      | 422 454,97 | 2 202 353,21 |
| 15                    | 82° 39' 10"              | 3,50                      | 422 455,36 | 2 202 356,73 |
| 16                    | 81° 46' 37"              | 3,50                      | 422 455,81 | 2 202 360,22 |
| 17                    | 80° 29' 47"              | 11,40                     | 422 456,31 | 2 202 363,68 |
| 18                    | 79° 31' 50"              | 5,60                      | 422 458,20 | 2 202 374,97 |
| 19                    | 79° 36' 20"              | 1,70                      | 422 459,22 | 2 202 380,49 |
| 20                    | 79° 15' 56"              | 2,10                      | 422 459,53 | 2 202 382,18 |
| 21                    | 79° 10' 3"               | 6,10                      | 422 459,93 | 2 202 384,29 |
| 22                    | 79° 54' 32"              | 19,20                     | 422 461,08 | 2 202 390,30 |
| 23                    | 121° 40' 25"             | 6,20                      | 422 464,44 | 2 202 409,18 |
| 24                    | 93° 57' 22"              | 5,40                      | 422 461,17 | 2 202 414,48 |

|    |              |        |            |              |
|----|--------------|--------|------------|--------------|
| 25 | 82° 59' 40"  | 2,40   | 422 460,80 | 2 202 419,83 |
| 26 | 76° 59' 14"  | 28,40  | 422 461,09 | 2 202 422,19 |
| 27 | 77° 35' 0"   | 10,00  | 422 467,48 | 2 202 449,84 |
| 28 | 77° 49' 58"  | 10,00  | 422 469,62 | 2 202 459,56 |
| 29 | 78° 23' 46"  | 19,90  | 422 471,72 | 2 202 469,30 |
| 30 | 79° 46' 40"  | 9,90   | 422 475,72 | 2 202 488,78 |
| 31 | 80° 36' 48"  | 9,90   | 422 477,48 | 2 202 498,54 |
| 32 | 81° 4' 42"   | 9,90   | 422 479,10 | 2 202 508,34 |
| 33 | 82° 3' 57"   | 9,90   | 422 480,64 | 2 202 518,15 |
| 34 | 82° 52' 55"  | 9,90   | 422 482,01 | 2 202 527,98 |
| 35 | 83° 41' 52"  | 20,00  | 422 483,24 | 2 202 537,83 |
| 36 | 83° 53' 56"  | 87,50  | 422 485,43 | 2 202 557,66 |
| 37 | 83° 53' 58"  | 37,70  | 422 494,73 | 2 202 644,67 |
| 38 | 91° 18' 7"   | 4,40   | 422 498,74 | 2 202 682,19 |
| 39 | 104° 23' 4"  | 4,40   | 422 498,64 | 2 202 686,59 |
| 40 | 116° 58' 33" | 4,40   | 422 497,55 | 2 202 690,84 |
| 41 | 129° 35' 10" | 4,30   | 422 495,57 | 2 202 694,73 |
| 42 | 141° 50' 7"  | 4,30   | 422 492,80 | 2 202 698,08 |
| 43 | 154° 22' 58" | 4,30   | 422 489,39 | 2 202 700,76 |
| 44 | 166° 46' 1"  | 4,30   | 422 485,49 | 2 202 702,63 |
| 45 | 179° 12' 15" | 4,30   | 422 481,28 | 2 202 703,62 |
| 46 | 190° 38' 13" | 4,00   | 422 476,96 | 2 202 703,68 |
| 47 | 197° 0' 5"   | 72,10  | 422 473,02 | 2 202 702,94 |
| 48 | 196° 49' 43" | 84,80  | 422 404,11 | 2 202 681,87 |
| 49 | 197° 14' 1"  | 61,40  | 422 322,91 | 2 202 657,31 |
| 50 | 287° 13' 53" | 135,40 | 422 264,27 | 2 202 639,12 |
| 51 | 285° 39' 21" | 29,10  | 422 304,37 | 2 202 509,83 |

|    |              |       |            |              |
|----|--------------|-------|------------|--------------|
| 52 | 285° 40' 11" | 15,10 | 422 312,22 | 2 202 481,82 |
| 53 | 280° 19' 38" | 31,80 | 422 316,31 | 2 202 467,24 |
| 54 | 273° 36' 19" | 31,80 | 422 322,01 | 2 202 435,96 |
| 55 | 266° 56' 9"  | 31,80 | 422 324,01 | 2 202 404,22 |
| 56 | 263° 35' 34" | 54,90 | 422 322,31 | 2 202 372,46 |
| 57 | 263° 34' 16" | 52,90 | 422 316,18 | 2 202 317,87 |
| 58 | 263° 39' 35" | 13,70 | 422 310,26 | 2 202 265,33 |
| 59 | 4° 17' 1"    | 2,70  | 422 308,75 | 2 202 251,74 |
| 60 | 5° 46' 22"   | 19,20 | 422 311,42 | 2 202 251,94 |
| 61 | 9° 17' 8"    | 19,20 | 422 330,51 | 2 202 253,87 |
| 62 | 11° 54' 14"  | 19,30 | 422 349,47 | 2 202 256,97 |
| 63 | 14° 1' 44"   | 19,30 | 422 368,35 | 2 202 260,95 |
| 64 | 14° 15' 6"   | 19,30 | 422 387,04 | 2 202 265,62 |
| 65 | 15° 43' 26"  | 19,20 | 422 405,78 | 2 202 270,38 |
| 66 | 16° 51' 55"  | 19,20 | 422 424,25 | 2 202 275,58 |
| 67 | 18° 51' 3"   | 19,20 | 422 442,59 | 2 202 281,14 |
| 68 | 20° 37' 54"  | 6,20  | 422 460,72 | 2 202 287,33 |

Площадь 69 950 кв. м

### Квартал 3

| №№<br>пун-кта | Дирекционный угол | Длина<br>линии, м | X          | Y            |
|---------------|-------------------|-------------------|------------|--------------|
| 1             | 84° 15' 8"        | 20,00             | 422 506,11 | 2 202 739,19 |
| 2             | 84° 14' 7"        | 122,60            | 422 508,11 | 2 202 759,06 |
| 3             | 354° 18' 22"      | 10,10             | 422 520,42 | 2 202 881,00 |
| 4             | 354° 13' 27"      | 14,90             | 422 530,45 | 2 202 880,00 |
| 5             | 84° 11' 59"       | 67,60             | 422 545,28 | 2 202 878,50 |

|    |              |       |            |              |
|----|--------------|-------|------------|--------------|
| 6  | 85° 22' 15"  | 12,00 | 422 552,11 | 2 202 945,74 |
| 7  | 85° 50' 34"  | 12,00 | 422 553,08 | 2 202 957,72 |
| 8  | 86° 33' 28"  | 12,00 | 422 553,95 | 2 202 969,69 |
| 9  | 88° 8' 57"   | 11,80 | 422 554,67 | 2 202 981,66 |
| 10 | 89° 15' 6"   | 12,30 | 422 555,05 | 2 202 993,42 |
| 11 | 90° 25' 41"  | 12,00 | 422 555,21 | 2 203 005,67 |
| 12 | 91° 51' 35"  | 12,00 | 422 555,12 | 2 203 017,71 |
| 13 | 92° 11' 29"  | 12,00 | 422 554,73 | 2 203 029,72 |
| 14 | 93° 56' 36"  | 12,10 | 422 554,27 | 2 203 041,74 |
| 15 | 94° 54' 21"  | 12,00 | 422 553,44 | 2 203 053,78 |
| 16 | 96° 20' 5"   | 12,10 | 422 552,41 | 2 203 065,78 |
| 17 | 96° 53' 23"  | 12,10 | 422 551,08 | 2 203 077,76 |
| 18 | 98° 19' 28"  | 12,10 | 422 549,63 | 2 203 089,76 |
| 19 | 99° 24' 56"  | 12,10 | 422 547,88 | 2 203 101,72 |
| 20 | 100° 33' 31" | 12,10 | 422 545,90 | 2 203 113,66 |
| 21 | 101° 42' 30" | 12,10 | 422 543,68 | 2 203 125,57 |
| 22 | 102° 51' 38" | 12,20 | 422 541,22 | 2 203 137,44 |
| 23 | 103° 51' 29" | 10,10 | 422 538,51 | 2 203 149,31 |
| 24 | 103° 56' 0"  | 12,20 | 422 536,08 | 2 203 159,16 |
| 25 | 106° 41' 8"  | 12,20 | 422 533,15 | 2 203 170,97 |
| 26 | 107° 34' 45" | 12,30 | 422 529,64 | 2 203 182,68 |
| 27 | 107° 33' 47" | 12,30 | 422 525,93 | 2 203 194,39 |
| 28 | 107° 36' 27" | 12,30 | 422 522,23 | 2 203 206,08 |
| 29 | 107° 33' 47" | 12,30 | 422 518,52 | 2 203 217,77 |
| 30 | 107° 34' 37" | 12,30 | 422 514,82 | 2 203 229,46 |
| 31 | 109° 27' 30" | 12,00 | 422 511,12 | 2 203 241,14 |
| 32 | 115° 52' 33" | 21,20 | 422 507,11 | 2 203 252,49 |

|    |              |        |            |              |
|----|--------------|--------|------------|--------------|
| 33 | 117° 49' 41" | 63,50  | 422 497,86 | 2 203 271,56 |
| 34 | 119° 45' 1"  | 63,50  | 422 468,22 | 2 203 327,71 |
| 35 | 121° 40' 38" | 63,50  | 422 436,71 | 2 203 382,84 |
| 36 | 123° 36' 58" | 10,70  | 422 403,37 | 2 203 436,87 |
| 37 | 213° 35' 2"  | 15,00  | 422 397,42 | 2 203 445,82 |
| 38 | 213° 37' 24" | 19,10  | 422 384,92 | 2 203 437,52 |
| 39 | 210° 44' 3"  | 233,40 | 422 369,01 | 2 203 426,94 |
| 40 | 210° 43' 42" | 15,00  | 422 168,41 | 2 203 307,67 |
| 41 | 210° 43' 53" | 117,60 | 422 155,49 | 2 203 299,99 |
| 42 | 210° 43' 25" | 109,00 | 422 054,38 | 2 203 239,88 |
| 43 | 300° 43' 56" | 91,70  | 421 960,71 | 2 203 184,21 |
| 44 | 300° 43' 42" | 85,60  | 422 007,57 | 2 203 105,39 |
| 45 | 300° 46' 31" | 12,00  | 422 051,32 | 2 203 031,79 |
| 46 | 300° 43' 54" | 170,40 | 422 057,46 | 2 203 021,48 |
| 47 | 300° 43' 42" | 15,00  | 422 144,52 | 2 202 875,04 |
| 48 | 300° 43' 56" | 143,90 | 422 152,20 | 2 202 862,12 |
| 49 | 299° 44' 41" | 10,00  | 422 225,73 | 2 202 738,44 |
| 50 | 297° 30' 47" | 10,00  | 422 230,69 | 2 202 729,76 |
| 51 | 295° 29' 34" | 10,00  | 422 235,31 | 2 202 720,89 |
| 52 | 293° 25' 30" | 10,00  | 422 239,63 | 2 202 711,83 |
| 53 | 291° 12' 21" | 10,00  | 422 243,59 | 2 202 702,69 |
| 54 | 289° 16' 6"  | 10,00  | 422 247,21 | 2 202 693,36 |
| 55 | 287° 30' 53" | 5,30   | 422 250,51 | 2 202 683,92 |
| 56 | 287° 2' 2"   | 16,60  | 422 252,11 | 2 202 678,85 |
| 57 | 16° 59' 56"  | 149,80 | 422 256,96 | 2 202 663,02 |
| 58 | 16° 59' 48"  | 93,90  | 422 400,20 | 2 202 706,81 |
| 59 | 17° 1' 4"    | 16,90  | 422 489,97 | 2 202 734,25 |

Площадь 284 372 кв. м

---

Квартал 4

| №№<br>пун-кта | Дирекционный угол | Длина<br>линии, м | X          | Y            |
|---------------|-------------------|-------------------|------------|--------------|
| 1             | 123° 35' 18"      | 17,20             | 422 377,75 | 2 203 475,40 |
| 2             | 121° 49' 43"      | 98,30             | 422 368,22 | 2 203 489,75 |
| 3             | 125° 56' 26"      | 91,30             | 422 316,39 | 2 203 573,25 |
| 4             | 125° 56' 36"      | 358,00            | 422 262,83 | 2 203 647,13 |
| 5             | 206° 10' 39"      | 15,20             | 422 052,70 | 2 203 936,95 |
| 6             | 206° 10' 40"      | 145,60            | 422 039,05 | 2 203 930,24 |
| 7             | 206° 19' 32"      | 50,30             | 421 908,39 | 2 203 866,01 |
| 8             | 302° 36' 38"      | 128,50            | 421 863,28 | 2 203 843,69 |
| 9             | 302° 37' 14"      | 51,40             | 421 932,55 | 2 203 735,42 |
| 10            | 302° 37' 26"      | 97,50             | 421 960,27 | 2 203 692,11 |
| 11            | 302° 37' 16"      | 77,00             | 422 012,83 | 2 203 610,00 |
| 12            | 302° 36' 32"      | 26,50             | 422 054,35 | 2 203 545,13 |
| 13            | 302° 36' 25"      | 39,80             | 422 068,61 | 2 203 522,84 |
| 14            | 302° 38' 50"      | 51,70             | 422 090,04 | 2 203 489,34 |
| 15            | 302° 38' 19"      | 100,70            | 422 117,91 | 2 203 445,84 |
| 16            | 299° 33' 6"       | 8,80              | 422 172,21 | 2 203 361,06 |
| 17            | 30° 51' 54"       | 10,00             | 422 176,57 | 2 203 353,37 |
| 18            | 28° 58' 58"       | 2,30              | 422 185,12 | 2 203 358,48 |
| 19            | 28° 48' 10"       | 9,50              | 422 187,16 | 2 203 359,61 |
| 20            | 31° 42' 46"       | 2,50              | 422 195,49 | 2 203 364,19 |
| 21            | 31° 49' 15"       | 31,60             | 422 197,61 | 2 203 365,50 |
| 22            | 31° 51' 55"       | 26,00             | 422 224,49 | 2 203 382,18 |

|    |             |        |            |              |
|----|-------------|--------|------------|--------------|
| 23 | 31° 12' 7"  | 118,30 | 422 246,61 | 2 203 395,93 |
| 24 | 31° 15' 30" | 20,00  | 422 347,82 | 2 203 457,23 |
| 25 | 31° 15' 53" | 15,00  | 422 364,92 | 2 203 467,61 |

Площадь 128 931 кв. м

---

### Квартал 5

| №№<br>пун-кта | Дирекционный угол | Длина<br>линии, м | X          | Y            |
|---------------|-------------------|-------------------|------------|--------------|
| 1             | 210° 42' 56"      | 23,00             | 422 116,01 | 2 202 834,97 |
| 2             | 210° 43' 42"      | 194,20            | 422 096,25 | 2 202 823,23 |
| 3             | 210° 43' 47"      | 50,00             | 421 929,35 | 2 202 724,02 |
| 4             | 210° 43' 27"      | 59,10             | 421 886,37 | 2 202 698,47 |
| 5             | 215° 15' 22"      | 0,70              | 421 835,59 | 2 202 668,29 |
| 6             | 215° 54' 35"      | 0,70              | 421 835,01 | 2 202 667,88 |
| 7             | 219° 24' 2"       | 0,70              | 421 834,43 | 2 202 667,46 |
| 8             | 222° 9' 57"       | 0,70              | 421 833,87 | 2 202 667,00 |
| 9             | 223° 19' 53"      | 0,70              | 421 833,34 | 2 202 666,52 |
| 10            | 226° 44' 8"       | 0,70              | 421 832,81 | 2 202 666,02 |
| 11            | 230° 42' 38"      | 0,70              | 421 832,33 | 2 202 665,51 |
| 12            | 234° 5' 24"       | 0,70              | 421 831,88 | 2 202 664,96 |
| 13            | 237° 12' 56"      | 0,70              | 421 831,46 | 2 202 664,38 |
| 14            | 241° 15' 36"      | 0,70              | 421 831,08 | 2 202 663,79 |
| 15            | 244° 53' 6"       | 0,70              | 421 830,74 | 2 202 663,17 |
| 16            | 248° 47' 26"      | 0,70              | 421 830,44 | 2 202 662,53 |
| 17            | 251° 18' 45"      | 0,70              | 421 830,18 | 2 202 661,86 |
| 18            | 253° 36' 37"      | 0,70              | 421 829,95 | 2 202 661,18 |
| 19            | 255° 34' 45"      | 0,70              | 421 829,75 | 2 202 660,50 |

|    |              |        |            |              |
|----|--------------|--------|------------|--------------|
| 20 | 258° 41' 24" | 0,70   | 421 829,57 | 2 202 659,80 |
| 21 | 259° 37' 26" | 0,70   | 421 829,43 | 2 202 659,10 |
| 22 | 263° 36' 34" | 13,80  | 421 829,30 | 2 202 658,39 |
| 23 | 263° 35' 31" | 68,10  | 421 827,76 | 2 202 644,64 |
| 24 | 263° 35' 28" | 12,00  | 421 820,16 | 2 202 576,97 |
| 25 | 263° 34' 55" | 40,70  | 421 818,82 | 2 202 565,04 |
| 26 | 263° 35' 40" | 198,50 | 421 814,27 | 2 202 524,59 |
| 27 | 263° 35' 6"  | 19,50  | 421 792,12 | 2 202 327,29 |
| 28 | 353° 55' 30" | 14,60  | 421 789,94 | 2 202 307,90 |
| 29 | 353° 56' 3"  | 111,80 | 421 804,41 | 2 202 306,36 |
| 30 | 353° 56' 49" | 131,40 | 421 915,55 | 2 202 294,55 |
| 31 | 353° 55' 1"  | 15,00  | 422 046,26 | 2 202 280,69 |
| 32 | 353° 56' 26" | 79,10  | 422 061,18 | 2 202 279,10 |
| 33 | 353° 56' 14" | 71,60  | 422 139,84 | 2 202 270,75 |
| 34 | 354° 6' 16"  | 1,80   | 422 211,02 | 2 202 263,19 |
| 35 | 354° 41' 33" | 1,80   | 422 212,86 | 2 202 263,00 |
| 36 | 354° 26' 33" | 1,90   | 422 214,69 | 2 202 262,83 |
| 37 | 355° 1' 48"  | 1,80   | 422 216,54 | 2 202 262,65 |
| 38 | 355° 1' 48"  | 1,80   | 422 218,38 | 2 202 262,49 |
| 39 | 355° 20' 22" | 1,80   | 422 220,22 | 2 202 262,33 |
| 40 | 356° 17' 19" | 1,90   | 422 222,06 | 2 202 262,18 |
| 41 | 355° 57' 31" | 1,80   | 422 223,91 | 2 202 262,06 |
| 42 | 356° 16' 6"  | 1,80   | 422 225,75 | 2 202 261,93 |
| 43 | 356° 34' 43" | 1,80   | 422 227,59 | 2 202 261,81 |
| 44 | 356° 54' 21" | 1,90   | 422 229,43 | 2 202 261,70 |
| 45 | 357° 12' 53" | 1,90   | 422 231,28 | 2 202 261,60 |
| 46 | 357° 31' 25" | 1,90   | 422 233,13 | 2 202 261,51 |

|    |              |        |            |              |
|----|--------------|--------|------------|--------------|
| 47 | 357° 49' 16" | 1,80   | 422 234,98 | 2 202 261,43 |
| 48 | 358° 8' 32"  | 1,90   | 422 236,82 | 2 202 261,36 |
| 49 | 358° 7' 56"  | 1,80   | 422 238,67 | 2 202 261,30 |
| 50 | 359° 4' 15"  | 1,90   | 422 240,51 | 2 202 261,24 |
| 51 | 358° 45' 16" | 1,80   | 422 242,36 | 2 202 261,21 |
| 52 | 359° 4' 15"  | 1,90   | 422 244,20 | 2 202 261,17 |
| 53 | 359° 41' 25" | 1,90   | 422 246,05 | 2 202 261,14 |
| 54 | 359° 41' 25" | 1,90   | 422 247,90 | 2 202 261,13 |
| 55 | 0° 18' 34"   | 1,90   | 422 249,75 | 2 202 261,12 |
| 56 | 0° 18' 34"   | 1,90   | 422 251,60 | 2 202 261,13 |
| 57 | 0° 37' 9"    | 1,90   | 422 253,45 | 2 202 261,14 |
| 58 | 0° 37' 9"    | 1,90   | 422 255,30 | 2 202 261,16 |
| 59 | 1° 33' 23"   | 1,80   | 422 257,15 | 2 202 261,18 |
| 60 | 1° 32' 53"   | 1,90   | 422 258,99 | 2 202 261,23 |
| 61 | 1° 51' 27"   | 1,90   | 422 260,84 | 2 202 261,28 |
| 62 | 2° 10' 0"    | 1,90   | 422 262,69 | 2 202 261,34 |
| 63 | 83° 35' 5"   | 49,00  | 422 264,54 | 2 202 261,41 |
| 64 | 83° 35' 13"  | 67,80  | 422 270,02 | 2 202 310,15 |
| 65 | 86° 55' 57"  | 26,50  | 422 277,59 | 2 202 377,50 |
| 66 | 93° 38' 27"  | 16,10  | 422 279,01 | 2 202 404,00 |
| 67 | 93° 36' 25"  | 10,50  | 422 277,99 | 2 202 420,03 |
| 68 | 100° 17' 7"  | 26,50  | 422 277,33 | 2 202 430,50 |
| 69 | 105° 35' 43" | 25,40  | 422 272,59 | 2 202 456,62 |
| 70 | 107° 5' 22"  | 151,50 | 422 265,76 | 2 202 481,09 |
| 71 | 107° 0' 19"  | 41,60  | 422 221,23 | 2 202 625,93 |
| 72 | 110° 26' 34" | 27,30  | 422 209,07 | 2 202 665,69 |
| 73 | 117° 14' 32" | 27,20  | 422 199,55 | 2 202 691,23 |

|    |              |       |            |              |
|----|--------------|-------|------------|--------------|
| 74 | 120° 44' 17" | 65,80 | 422 187,08 | 2 202 715,45 |
| 75 | 120° 43' 48" | 57,20 | 422 153,44 | 2 202 772,02 |
| 76 | 120° 45' 19" | 16,00 | 422 124,21 | 2 202 821,19 |

Площадь 203 838 кв. м

---

### Квартал 6

| №№<br>пун-кта | Дирекционный угол | Длина<br>линии, м | X          | Y            |
|---------------|-------------------|-------------------|------------|--------------|
| 1             | 83° 35' 11"       | 174,30            | 421 765,08 | 2 202 310,55 |
| 2             | 83° 35' 9"        | 12,00             | 421 784,55 | 2 202 483,76 |
| 3             | 83° 35' 12"       | 124,70            | 421 785,89 | 2 202 495,68 |
| 4             | 83° 35' 54"       | 16,50             | 421 799,82 | 2 202 619,61 |
| 5             | 83° 35' 10"       | 25,00             | 421 801,66 | 2 202 636,01 |
| 6             | 80° 47' 20"       | 1,10              | 421 804,45 | 2 202 660,83 |
| 7             | 80° 0' 45"        | 1,60              | 421 804,63 | 2 202 661,94 |
| 8             | 78° 24' 59"       | 1,60              | 421 804,91 | 2 202 663,53 |
| 9             | 76° 8' 4"         | 1,60              | 421 805,24 | 2 202 665,14 |
| 10            | 74° 0' 23"        | 1,60              | 421 805,63 | 2 202 666,72 |
| 11            | 72° 53' 50"       | 1,60              | 421 806,08 | 2 202 668,29 |
| 12            | 69° 53' 48"       | 1,60              | 421 806,56 | 2 202 669,85 |
| 13            | 67° 24' 26"       | 1,60              | 421 807,12 | 2 202 671,38 |
| 14            | 65° 10' 31"       | 1,60              | 421 807,74 | 2 202 672,87 |
| 15            | 62° 39' 0"        | 1,60              | 421 808,42 | 2 202 674,34 |
| 16            | 59° 46' 9"        | 1,60              | 421 809,17 | 2 202 675,79 |
| 17            | 56° 36' 17"       | 1,60              | 421 809,98 | 2 202 677,18 |
| 18            | 53° 50' 30"       | 1,60              | 421 810,87 | 2 202 678,53 |
| 19            | 51° 17' 5"        | 1,60              | 421 811,82 | 2 202 679,83 |

|    |              |        |            |              |
|----|--------------|--------|------------|--------------|
| 20 | 48° 14' 56"  | 1,60   | 421 812,83 | 2 202 681,09 |
| 21 | 46° 29' 39"  | 1,60   | 421 813,91 | 2 202 682,30 |
| 22 | 44° 0' 13"   | 1,60   | 421 815,03 | 2 202 683,48 |
| 23 | 41° 32' 48"  | 1,60   | 421 816,20 | 2 202 684,61 |
| 24 | 38° 46' 10"  | 1,60   | 421 817,43 | 2 202 685,70 |
| 25 | 38° 46' 10"  | 1,60   | 421 818,70 | 2 202 686,72 |
| 26 | 35° 49' 18"  | 1,60   | 421 819,97 | 2 202 687,74 |
| 27 | 34° 22' 49"  | 1,60   | 421 821,30 | 2 202 688,70 |
| 28 | 30° 44' 23"  | 143,00 | 421 822,63 | 2 202 689,61 |
| 29 | 30° 44' 4"   | 15,00  | 421 945,55 | 2 202 762,71 |
| 30 | 30° 44' 18"  | 168,40 | 421 958,45 | 2 202 770,38 |
| 31 | 120° 44' 16" | 184,50 | 422 103,22 | 2 202 856,47 |
| 32 | 120° 44' 10" | 170,10 | 422 008,92 | 2 203 015,05 |
| 33 | 210° 44' 52" | 168,10 | 421 922,00 | 2 203 161,23 |
| 34 | 210° 45' 14" | 15,00  | 421 777,57 | 2 203 075,31 |
| 35 | 210° 45' 1"  | 171,80 | 421 764,68 | 2 203 067,64 |
| 36 | 210° 42' 19" | 5,30   | 421 617,07 | 2 202 979,82 |
| 37 | 214° 24' 33" | 8,60   | 421 612,49 | 2 202 977,10 |
| 38 | 216° 52' 11" | 2,10   | 421 605,38 | 2 202 972,23 |
| 39 | 216° 51' 8"  | 6,50   | 421 603,70 | 2 202 970,97 |
| 40 | 219° 27' 59" | 8,70   | 421 598,47 | 2 202 967,05 |
| 41 | 221° 57' 45" | 8,70   | 421 591,79 | 2 202 961,55 |
| 42 | 224° 18' 2"  | 8,70   | 421 585,34 | 2 202 955,75 |
| 43 | 226° 40' 35" | 8,70   | 421 579,12 | 2 202 949,68 |
| 44 | 229° 6' 19"  | 8,70   | 421 573,15 | 2 202 943,35 |
| 45 | 231° 25' 57" | 8,70   | 421 567,46 | 2 202 936,78 |
| 46 | 233° 40' 57" | 8,70   | 421 562,03 | 2 202 929,97 |

|    |              |        |            |              |
|----|--------------|--------|------------|--------------|
| 47 | 235° 57' 46" | 8,70   | 421 556,87 | 2 202 922,95 |
| 48 | 238° 16' 1"  | 8,70   | 421 552,00 | 2 202 915,74 |
| 49 | 240° 37' 27" | 8,70   | 421 547,43 | 2 202 908,35 |
| 50 | 242° 48' 45" | 8,60   | 421 543,18 | 2 202 900,80 |
| 51 | 245° 2' 6"   | 8,60   | 421 539,23 | 2 202 893,11 |
| 52 | 247° 6' 53"  | 8,60   | 421 535,58 | 2 202 885,27 |
| 53 | 249° 1' 27"  | 8,60   | 421 532,22 | 2 202 877,31 |
| 54 | 250° 56' 7"  | 8,60   | 421 529,13 | 2 202 869,25 |
| 55 | 252° 45' 38" | 8,60   | 421 526,31 | 2 202 861,09 |
| 56 | 254° 19' 37" | 8,70   | 421 523,75 | 2 202 852,84 |
| 57 | 255° 59' 45" | 8,60   | 421 521,41 | 2 202 844,50 |
| 58 | 257° 30' 25" | 8,60   | 421 519,32 | 2 202 836,12 |
| 59 | 258° 54' 40" | 8,60   | 421 517,45 | 2 202 827,68 |
| 60 | 260° 15' 2"  | 3,00   | 421 515,79 | 2 202 819,21 |
| 61 | 260° 9' 20"  | 5,70   | 421 515,29 | 2 202 816,30 |
| 62 | 263° 39' 59" | 9,30   | 421 514,32 | 2 202 810,71 |
| 63 | 263° 39' 21" | 111,50 | 421 513,29 | 2 202 801,43 |
| 64 | 263° 39' 18" | 319,30 | 421 500,97 | 2 202 690,62 |
| 65 | 263° 38' 19" | 12,00  | 421 465,68 | 2 202 373,25 |
| 66 | 352° 34' 43" | 12,00  | 421 464,35 | 2 202 361,32 |
| 67 | 352° 34' 58" | 32,60  | 421 476,25 | 2 202 359,77 |
| 68 | 356° 26' 7"  | 3,10   | 421 508,59 | 2 202 355,56 |
| 69 | 263° 38' 44" | 17,80  | 421 511,64 | 2 202 355,37 |
| 70 | 353° 56' 10" | 73,50  | 421 509,67 | 2 202 337,68 |
| 71 | 353° 56' 12" | 183,40 | 421 582,72 | 2 202 329,92 |

Площадь 286 052 кв. м

---

## Контур красной линии 1

| Обозначение<br>характерных точек<br>границ | X, м       | Y, м      | Мера<br>линий, м | Дирек. углы,<br>град мин сек |
|--|------------|-----------|------------------|------------------------------|
| 1  | 2203252,49 | 422507,11 | 42,3             | 295°53,2'                    |
| 2  | 2203214,44 | 422525,58 | 63,5             | 293°57,2'                    |
| 3  | 2203156,41 | 422551,36 | 47,61            | 292°17,3'                    |
| 4  | 2203112,36 | 422569,42 | 41,28            | 290°45'                      |
| 5  | 2203073,76 | 422584,04 | 28,57            | 289°08,7'                    |
| 6  | 2203046,77 | 422593,41 | 28,56            | 288°17'                      |
| 7  | 2203019,65 | 422602,37 | 28,57            | 287°24,8'                    |
| 8  | 2202992,39 | 422610,92 | 28,57            | 286°35,7'                    |
| 9  | 2202965,01 | 422619,08 | 28,56            | 285°44,7'                    |
| 10   | 2202937,52 | 422626,83 | 28,56            | 284°50,9'                    |
| 11   | 2202909,91 | 422634,15 | 28,56            | 284°00,1'                    |
| 12   | 2202882,2  | 422641,06 | 28,57            | 283°07,9'                    |
| 13   | 2202854,38 | 422647,55 | 17,8             | 282°17,7'                    |
| 14   | 2202836,99 | 422651,34 | 6,46             | 282°20,2'                    |
| 15   | 2202830,68 | 422652,72 | 4,31             | 282°44,7'                    |
| 16   | 2202826,48 | 422653,67 | 15,33            | 281°28,7'                    |
| 17   | 2202811,46 | 422656,72 | 13,57            | 281°13,1'                    |
| 18   | 2202798,15 | 422659,36 | 11,63            | 280°57,2'                    |
| 19   | 2202786,73 | 422661,57 | 17,44            | 280°16,4'                    |
| 20   | 2202769,57 | 422664,68 |                  |                              |

|    |            |           |       |           |
|----|------------|-----------|-------|-----------|
|    |            |           | 7,74  | 280°02,8' |
| 21 | 2202761,95 | 422666,03 | 3,92  | 259°51,9' |
| 22 | 2202758,09 | 422665,34 | 3,93  | 255°23,9' |
| 23 | 2202754,29 | 422664,35 | 8,47  | 248°14,9' |
| 24 | 2202746,42 | 422661,21 | 8,27  | 242°00,5' |
| 25 | 2202739,12 | 422657,33 | 9,74  | 238°25,9' |
| 26 | 2202730,82 | 422652,23 | 11,13 | 235°12,6' |
| 27 | 2202721,68 | 422645,88 | 9,71  | 233°22,7' |
| 28 | 2202713,89 | 422640,09 | 11,05 | 232°41,1' |
| 29 | 2202705,1  | 422633,39 | 41,68 | 233°29,3' |
| 30 | 2202671,6  | 422608,59 | 11,38 | 233°36,8' |
| 31 | 2202662,44 | 422601,84 | 12,11 | 234°16,5' |
| 32 | 2202652,61 | 422594,77 | 12,84 | 235°34'   |
| 33 | 2202642,02 | 422587,51 | 13,59 | 237°33,7' |
| 34 | 2202630,55 | 422580,22 | 11,65 | 239°52,3' |
| 35 | 2202620,47 | 422574,37 | 12,16 | 242°27,9' |
| 36 | 2202609,69 | 422568,75 | 12,65 | 245°28,9' |
| 37 | 2202598,18 | 422563,5  | 11,34 | 248°51,9' |
| 38 | 2202587,6  | 422559,41 | 50,26 | 99°27,7'  |
| 39 | 2202637,17 | 422551,15 | 99,46 | 96°33,7'  |
| 40 | 2202735,98 | 422539,78 | 28,75 | 102°06,8' |
| 41 | 2202764,09 | 422533,75 | 26,01 | 353°53,2' |

|    |            |           |       |           |
|----|------------|-----------|-------|-----------|
| 42 | 2202761,32 | 422559,61 |       |           |
|    |            |           | 85,01 | 83°53,3'  |
| 43 | 2202845,84 | 422568,66 |       |           |
|    |            |           | 26,53 | 173°55,6' |
| 44 | 2202848,65 | 422542,28 |       |           |
|    |            |           | 30    | 84°15,7'  |
| 45 | 2202878,5  | 422545,28 |       |           |
|    |            |           | 67,59 | 84°12,1'  |
| 46 | 2202945,74 | 422552,11 |       |           |
|    |            |           | 12,02 | 85°21,5'  |
| 47 | 2202957,72 | 422553,08 |       |           |
|    |            |           | 12    | 85°50,5'  |
| 48 | 2202969,69 | 422553,95 |       |           |
|    |            |           | 11,99 | 86°33,4'  |
| 49 | 2202981,66 | 422554,67 |       |           |
|    |            |           | 11,77 | 88°09,1'  |
| 50 | 2202993,42 | 422555,05 |       |           |
|    |            |           | 12,24 | 89°16,6'  |
| 51 | 2203005,67 | 422555,21 |       |           |
|    |            |           | 12,05 | 90°24,7'  |
| 52 | 2203017,71 | 422555,12 |       |           |
|    |            |           | 12,02 | 91°50,7'  |
| 53 | 2203029,72 | 422554,73 |       |           |
|    |            |           | 12,03 | 92°12,5'  |
| 54 | 2203041,74 | 422554,27 |       |           |
|    |            |           | 12,07 | 93°56,1'  |
| 55 | 2203053,78 | 422553,44 |       |           |
|    |            |           | 12,05 | 94°55'    |
| 56 | 2203065,78 | 422552,41 |       |           |
|    |            |           | 12,06 | 96°19,4'  |
| 57 | 2203077,76 | 422551,08 |       |           |
|    |            |           | 12,08 | 96°53,6'  |
| 58 | 2203089,76 | 422549,63 |       |           |
|    |            |           | 12,09 | 98°18,2'  |
| 59 | 2203101,72 | 422547,88 |       |           |
|    |            |           | 12,1  | 99°26,1'  |
| 60 | 2203113,66 | 422545,9  |       |           |
|    |            |           | 12,12 | 100°34'   |
| 61 | 2203125,57 | 422543,68 |       |           |
|    |            |           | 12,12 | 101°42,1' |
| 62 | 2203137,44 | 422541,22 |       |           |
|    |            |           | 12,18 | 102°50,2' |
| 63 | 2203149,31 | 422538,51 |       |           |

|    |            |           |       |           |
|----|------------|-----------|-------|-----------|
|    |            |           | 10,15 | 103°53,1' |
| 64 | 2203159,16 | 422536,08 | 12,17 | 103°55,7' |
| 65 | 2203170,97 | 422533,15 | 12,22 | 106°41,6' |
| 66 | 2203182,68 | 422529,64 | 12,28 | 107°34,5' |
| 67 | 2203194,39 | 422525,93 | 12,26 | 107°34,6' |
| 68 | 2203206,08 | 422522,23 | 12,26 | 107°34,6' |
| 69 | 2203217,77 | 422518,52 | 12,26 | 107°34,6' |
| 70 | 2203229,46 | 422514,82 | 12,25 | 107°34,7' |
| 71 | 2203241,14 | 422511,12 | 12,04 | 109°26,5' |
| 1  | 2203252,49 | 422507,11 |       |           |

Площадь 37 350 кв. м

### Контур красной линии 2

| Обозначение<br>характерных точек<br>границ | X, м       | Y, м      | Мера<br>линий, м | Дирек. углы,<br>град мин сек |
|--|------------|-----------|------------------|------------------------------|
| 386  | 2202703,68 | 422476,96 | 4,32             | 359°10,9'                    |
| 387  | 2202703,62 | 422481,28 | 4,32             | 346°46,5'                    |
| 388  | 2202702,63 | 422485,49 | 4,33             | 334°21,8'                    |
| 389  | 2202700,76 | 422489,39 | 4,33             | 321°56'                      |
| 390  | 2202698,08 | 422492,8  | 4,35             | 309°28,3'                    |
| 391  | 2202694,73 | 422495,57 | 4,37             | 296°58'                      |
| 392  | 2202690,84 | 422497,55 | 4,39             | 284°24,4'                    |
| 393  | 2202686,59 | 422498,64 | 4,41             | 271°21,6'                    |

|     |            |           |       |           |
|-----|------------|-----------|-------|-----------|
| 394 | 2202682,19 | 422498,74 |       |           |
|     |            |           | 37,73 | 263°53,7' |
| 395 | 2202644,67 | 422494,73 |       |           |
|     |            |           | 87,5  | 263°53,7' |
| 396 | 2202557,66 | 422485,43 |       |           |
|     |            |           | 19,95 | 263°42,3' |
| 397 | 2202537,83 | 422483,24 |       |           |
|     |            |           | 9,93  | 262°51,6' |
| 398 | 2202527,98 | 422482,01 |       |           |
|     |            |           | 9,92  | 262°04,4' |
| 399 | 2202518,15 | 422480,64 |       |           |
|     |            |           | 9,93  | 261°05,7' |
| 400 | 2202508,34 | 422479,1  |       |           |
|     |            |           | 9,93  | 260°35,5' |
| 401 | 2202498,54 | 422477,48 |       |           |
|     |            |           | 9,92  | 259°48,1' |
| 402 | 2202488,78 | 422475,72 |       |           |
|     |            |           | 19,88 | 258°24,4' |
| 403 | 2202469,3  | 422471,72 |       |           |
|     |            |           | 9,96  | 257°47,7' |
| 404 | 2202459,56 | 422469,62 |       |           |
|     |            |           | 9,96  | 257°37,1' |
| 405 | 2202449,84 | 422467,48 |       |           |
|     |            |           | 28,37 | 256°58,8' |
| 406 | 2202422,19 | 422461,09 |       |           |
|     |            |           | 2,38  | 262°55,2' |
| 407 | 2202419,83 | 422460,8  |       |           |
|     |            |           | 5,36  | 273°57,4' |
| 408 | 2202414,48 | 422461,17 |       |           |
|     |            |           | 6,23  | 301°43,7' |
| 409 | 2202409,18 | 422464,44 |       |           |
|     |            |           | 19,18 | 259°54,6' |
| 410 | 2202390,3  | 422461,08 |       |           |
|     |            |           | 6,12  | 259°09,3' |
| 411 | 2202384,29 | 422459,93 |       |           |
|     |            |           | 2,15  | 259°10,6' |
| 412 | 2202382,18 | 422459,53 |       |           |
|     |            |           | 1,72  | 259°35,4' |
| 413 | 2202380,49 | 422459,22 |       |           |
|     |            |           | 5,61  | 259°35,4' |
| 414 | 2202374,97 | 422458,2  |       |           |
|     |            |           | 11,45 | 260°28,1' |
| 415 | 2202363,68 | 422456,31 |       |           |

|     |            |           |       |           |
|-----|------------|-----------|-------|-----------|
|     |            |           | 3,49  | 261°48'   |
| 416 | 2202360,22 | 422455,81 | 3,52  | 262°40,1' |
| 417 | 2202356,73 | 422455,36 | 3,55  | 263°39,6' |
| 418 | 2202353,21 | 422454,97 | 7,18  | 265°26'   |
| 419 | 2202346,06 | 422454,4  | 3,63  | 267°27,9' |
| 420 | 2202342,43 | 422454,24 | 3,67  | 268°59,1' |
| 421 | 2202338,76 | 422454,17 | 5,4   | 271°22,1' |
| 422 | 2202333,36 | 422454,3  | 2,36  | 3°39,9'   |
| 423 | 2202333,51 | 422456,66 | 3,38  | 273°29,1' |
| 424 | 2202330,14 | 422456,86 | 6,37  | 276°14,5' |
| 425 | 2202323,81 | 422457,56 | 5,75  | 279°29,4' |
| 426 | 2202318,13 | 422458,5  | 6,94  | 282°01,9' |
| 427 | 2202311,35 | 422459,95 | 6,32  | 284°35,5' |
| 428 | 2202305,23 | 422461,54 | 6,31  | 286°26,8' |
| 429 | 2202299,18 | 422463,33 | 6,29  | 287°50,3' |
| 430 | 2202293,19 | 422465,26 | 3,88  | 288°46'   |
| 98  | 2202289,51 | 422466,51 | 6,19  | 200°40,2' |
| 431 | 2202287,33 | 422460,72 | 19,16 | 198°50,2' |
| 432 | 2202281,14 | 422442,59 | 19,16 | 196°53,6' |
| 433 | 2202275,58 | 422424,25 | 19,19 | 195°42,4' |
| 434 | 2202270,38 | 422405,78 | 19,33 | 194°15,1' |
| 435 | 2202265,62 | 422387,04 | 19,26 | 194°02,4' |

|     |            |           |        |           |
|-----|------------|-----------|--------|-----------|
| 436 | 2202260,95 | 422368,35 |        |           |
|     |            |           | 19,3   | 191°54'   |
| 437 | 2202256,97 | 422349,47 |        |           |
|     |            |           | 19,21  | 189°16,7' |
| 438 | 2202253,87 | 422330,51 |        |           |
|     |            |           | 19,19  | 185°47,2' |
| 439 | 2202251,94 | 422311,42 |        |           |
|     |            |           | 2,68   | 184°12,7' |
| 440 | 2202251,74 | 422308,75 |        |           |
|     |            |           | 13,67  | 83°40'    |
| 441 | 2202265,33 | 422310,26 |        |           |
|     |            |           | 52,87  | 83°34,5'  |
| 442 | 2202317,87 | 422316,18 |        |           |
|     |            |           | 54,93  | 83°35,6'  |
| 443 | 2202372,46 | 422322,31 |        |           |
|     |            |           | 31,81  | 86°56,2'  |
| 444 | 2202404,22 | 422324,01 |        |           |
|     |            |           | 31,8   | 93°36,3'  |
| 445 | 2202435,96 | 422322,01 |        |           |
|     |            |           | 31,8   | 100°19,6' |
| 446 | 2202467,24 | 422316,31 |        |           |
|     |            |           | 15,14  | 105°39,6' |
| 447 | 2202481,82 | 422312,22 |        |           |
|     |            |           | 29,09  | 105°39,6' |
| 448 | 2202509,83 | 422304,37 |        |           |
|     |            |           | 135,37 | 107°13,9' |
| 449 | 2202639,12 | 422264,27 |        |           |
|     |            |           | 61,4   | 17°13,9'  |
| 450 | 2202657,31 | 422322,91 |        |           |
|     |            |           | 84,83  | 16°49,9'  |
| 451 | 2202681,87 | 422404,11 |        |           |
|     |            |           | 72,06  | 16°60'    |
| 452 | 2202702,94 | 422473,02 |        |           |
|     |            |           | 4,01   | 10°36,5'  |
| 386 | 2202703,68 | 422476,96 |        |           |

Площадь 69 950 кв. м

---

## Контур красной линии 3

| Обозначение<br>характерных точек<br>границ | X, м       | Y, м      | Мера<br>линий, м | Дирек. углы,<br>град мин сек |
|--|------------|-----------|------------------|------------------------------|
| 211  | 2202652,05 | 421902,61 | 30,65            | 353°52,9'                    |
| 212  | 2202648,78 | 421933,09 | 12               | 353°52,9'                    |
| 213  | 2202647,5  | 421945,02 | 162,1            | 353°52,9'                    |
| 214  | 2202630,23 | 422106,2  | 190,35           | 263°52,9'                    |
| 215  | 2202440,96 | 422085,91 | 22,35            | 173°50,7'                    |
| 216  | 2202443,36 | 422063,7  | 163,61           | 263°52,9'                    |
| 217  | 2202280,69 | 422046,26 | 131,44           | 173°56,6'                    |
| 312  | 2202294,55 | 421915,55 | 111,77           | 173°56,2'                    |
| 313  | 2202306,36 | 421804,41 | 14,55            | 173°55,2'                    |
| 314  | 2202307,9  | 421789,94 | 19,51            | 83°35,6'                     |
| 315  | 2202327,29 | 421792,12 | 198,54           | 83°35,6'                     |
| 316  | 2202524,59 | 421814,27 | 40,71            | 83°35,6'                     |
| 317  | 2202565,04 | 421818,82 | 12               | 83°35,6'                     |
| 318  | 2202576,97 | 421820,16 | 68,1             | 83°35,6'                     |
| 208  | 2202644,64 | 421827,76 | 58,58            | 353°35,2'                    |
| 209  | 2202638,1  | 421885,97 | 15,06            | 353°36,4'                    |
| 210  | 2202636,42 | 421900,94 | 15,72            | 83°52,9'                     |
| 211  | 2202652,05 | 421902,61 |                  |                              |

Площадь 94 055 кв. м

## Контур красной линии 4

| Обозначение<br>характерных точек<br>гранец | X, м       | Y, м      | Мера<br>линий, м | Дирек. углы,<br>град мин сек |
|--|------------|-----------|------------------|------------------------------|
| 123  | 2203437,52 | 422384,92 | 10,8             | 303°36,9'                    |
| 124  | 2203428,52 | 422390,9  | 62,99            | 301°40,8'                    |
| 125  | 2203374,91 | 422423,98 | 25,83            | 299°44,1'                    |
| 126  | 2203352,49 | 422436,79 | 37,16            | 299°44,1'                    |
| 127  | 2203320,22 | 422455,22 | 62,98            | 297°49'                      |
| 128  | 2203264,52 | 422484,61 | 20,65            | 295°52,1'                    |
| 129  | 2203245,93 | 422493,62 | 10,09            | 288°54,2'                    |
| 130  | 2203236,38 | 422496,89 | 12,02            | 287°34,6'                    |
| 131  | 2203224,93 | 422500,52 | 12,2             | 286°38,7'                    |
| 132  | 2203213,24 | 422504,02 | 12,33            | 288°29,9'                    |
| 133  | 2203201,55 | 422507,93 | 12,26            | 288°29,9'                    |
| 134  | 2203189,92 | 422511,82 | 12,27            | 286°39,3'                    |
| 135  | 2203178,17 | 422515,33 | 12,02            | 286°41,1'                    |
| 136  | 2203166,66 | 422518,78 | 11,43            | 283°50,5'                    |
| 137  | 2203155,56 | 422521,52 | 10,01            | 283°52,9'                    |
| 138  | 2203145,84 | 422523,92 | 12,02            | 282°50,3'                    |
| 139  | 2203134,12 | 422526,59 | 11,84            | 281°41,3'                    |
| 140  | 2203122,52 | 422528,99 | 11,84            | 280°33,2'                    |
| 141  | 2203110,89 | 422531,16 | 13,7             | 232°38,5'                    |
| 142  | 2203100    | 422522,84 |                  |                              |

|     |            |           |        |           |
|-----|------------|-----------|--------|-----------|
|     |            |           | 198,46 | 210°44,2' |
| 143 | 2202998,57 | 422352,27 | 130,51 | 120°44,6' |
| 144 | 2203110,74 | 422285,55 | 130,51 | 120°44,6' |
| 145 | 2203222,9  | 422218,83 | 98,63  | 120°44,6' |
| 146 | 2203307,67 | 422168,41 | 233,38 | 30°44'    |
| 371 | 2203426,94 | 422369,01 | 19,1   | 33°37,4'  |
| 123 | 2203437,52 | 422384,92 |        |           |

Площадь 87 694 кв. м

---

#### Контур красной линии 5

| Обозначение<br>характерных точек<br>границ | X, м       | Y, м      | Мера<br>линий, м | Дирек. углы,<br>град мин сек |
|--|------------|-----------|------------------|------------------------------|
| 147  | 2203299,99 | 422155,49 | 98,63            | 300°44,6'                    |
| 148  | 2203215,22 | 422205,91 | 90,68            | 300°44,6'                    |
| 149  | 2203137,28 | 422252,27 | 158,29           | 300°44,6'                    |
| 150  | 2203001,24 | 422333,19 | 12               | 300°44,6'                    |
| 151  | 2202990,92 | 422339,32 | 12               | 210°44,9'                    |
| 152  | 2202984,79 | 422329,01 | 105,63           | 210°44,7'                    |
| 153  | 2202930,79 | 422238,23 | 109,04           | 210°45,1'                    |
| 154  | 2202875,04 | 422144,52 | 170,37           | 120°43,9'                    |
| 366  | 2203021,48 | 422057,46 | 12               | 120°43,9'                    |
| 367  | 2203031,79 | 422051,32 | 85,62            | 120°43,9'                    |
| 368  | 2203105,39 | 422007,57 |                  |                              |

|     |            |           |        |           |
|-----|------------|-----------|--------|-----------|
|     |            |           | 91,69  | 120°43,8' |
| 369 | 2203184,21 | 421960,71 | 108,96 | 30°43,5'  |
| 370 | 2203239,88 | 422054,38 | 117,63 | 30°43,9'  |
| 147 | 2203299,99 | 422155,49 |        |           |

Площадь 81 507 кв. м

### Контур красной линии б

| Обозначение<br>характерных точек<br>границ | X, м       | Y, м      | Мера<br>линий, м | Дирек. углы,<br>град мин сек |
|--|------------|-----------|------------------|------------------------------|
| 161  | 2203930,24 | 422039,05 | 159,22           | 305°56,3'                    |
| 162  | 2203801,33 | 422132,5  | 85,75            | 305°56,5'                    |
| 163  | 2203731,91 | 422182,83 | 12               | 305°56,5'                    |
| 164  | 2203722,19 | 422189,87 | 103,65           | 305°56,5'                    |
| 165  | 2203638,27 | 422250,71 | 90,72            | 305°56,6'                    |
| 166  | 2203564,83 | 422303,96 | 98,2             | 301°50'                      |
| 167  | 2203481,4  | 422355,76 | 16,56            | 303°35,5'                    |
| 155  | 2203467,61 | 422364,92 | 20               | 211°15,7'                    |
| 453  | 2203457,23 | 422347,82 | 118,33           | 211°12,1'                    |
| 454  | 2203395,93 | 422246,61 | 26,05            | 211°51,9'                    |
| 455  | 2203382,18 | 422224,49 | 31,63            | 211°48,8'                    |
| 456  | 2203365,5  | 422197,61 | 2,49             | 211°48,8'                    |
| 457  | 2203364,19 | 422195,49 | 9,5              | 208°50,3'                    |
| 458  | 2203359,61 | 422187,16 |                  |                              |

|     |            |           |        |           |
|-----|------------|-----------|--------|-----------|
|     |            |           | 2,33   | 208°50,3' |
| 459 | 2203358,48 | 422185,12 | 9,96   | 210°51,9' |
| 460 | 2203353,37 | 422176,57 | 8,84   | 119°33,1' |
| 461 | 2203361,06 | 422172,21 | 100,68 | 122°38,5' |
| 462 | 2203445,84 | 422117,91 | 51,66  | 122°38,5' |
| 463 | 2203489,34 | 422090,04 | 39,77  | 122°36,5' |
| 464 | 2203522,84 | 422068,61 | 26,46  | 122°36,5' |
| 465 | 2203545,13 | 422054,35 | 77,02  | 122°37,3' |
| 466 | 2203610    | 422012,83 | 97,49  | 122°37,3' |
| 467 | 2203692,11 | 421960,27 | 51,42  | 122°37,3' |
| 468 | 2203735,42 | 421932,55 | 128,53 | 122°36,6' |
| 469 | 2203843,69 | 421863,28 | 50,33  | 26°19,5'  |
| 470 | 2203866,01 | 421908,39 | 145,59 | 26°10,7'  |
| 161 | 2203930,24 | 422039,05 |        |           |

Площадь 120 448 кв. м

Контур красной линии 7

| Обозначение<br>характерных точек<br>границ | X, м       | Y, м      | Мера<br>линий, м | Дирек. углы,<br>град мин сек |
|--|------------|-----------|------------------|------------------------------|
| 319  | 2202834,97 | 422116,01 | 16,04            | 300°44,2'                    |
| 320  | 2202821,19 | 422124,21 | 57,2             | 300°44,2'                    |
| 321  | 2202772,02 | 422153,44 | 65,82            | 300°44,3'                    |
| 322  | 2202715,45 | 422187,08 |                  |                              |

|     |            |           |        |           |
|-----|------------|-----------|--------|-----------|
|     |            |           | 27,24  | 297°14,5' |
| 323 | 2202691,23 | 422199,55 |        |           |
|     |            |           | 27,26  | 290°26,6' |
| 324 | 2202665,69 | 422209,07 |        |           |
|     |            |           | 41,58  | 287°00,3' |
| 325 | 2202625,93 | 422221,23 |        |           |
|     |            |           | 151,53 | 287°05,4' |
| 326 | 2202481,09 | 422265,76 |        |           |
|     |            |           | 25,41  | 285°35,7' |
| 327 | 2202456,62 | 422272,59 |        |           |
|     |            |           | 26,55  | 280°17,1' |
| 328 | 2202430,5  | 422277,33 |        |           |
|     |            |           | 10,5   | 273°37,6' |
| 329 | 2202420,03 | 422277,99 |        |           |
|     |            |           | 16,06  | 273°37,7' |
| 330 | 2202404    | 422279,01 |        |           |
|     |            |           | 26,54  | 266°56'   |
| 331 | 2202377,5  | 422277,59 |        |           |
|     |            |           | 67,77  | 263°35,2' |
| 332 | 2202310,15 | 422270,02 |        |           |
|     |            |           | 49,05  | 263°35,1' |
| 333 | 2202261,41 | 422264,54 |        |           |
|     |            |           | 1,85   | 182°10'   |
| 334 | 2202261,34 | 422262,69 |        |           |
|     |            |           | 1,85   | 181°51,5' |
| 335 | 2202261,28 | 422260,84 |        |           |
|     |            |           | 1,85   | 181°32,9' |
| 336 | 2202261,23 | 422258,99 |        |           |
|     |            |           | 1,84   | 181°33,4' |
| 337 | 2202261,18 | 422257,15 |        |           |
|     |            |           | 1,85   | 180°37,2' |
| 338 | 2202261,16 | 422255,3  |        |           |
|     |            |           | 1,85   | 180°37,2' |
| 339 | 2202261,14 | 422253,45 |        |           |
|     |            |           | 1,85   | 180°18,5' |
| 340 | 2202261,13 | 422251,6  |        |           |
|     |            |           | 1,85   | 180°18,6' |
| 341 | 2202261,12 | 422249,75 |        |           |
|     |            |           | 1,85   | 179°41,4' |
| 342 | 2202261,13 | 422247,9  |        |           |
|     |            |           | 1,85   | 179°41,4' |
| 343 | 2202261,14 | 422246,05 |        |           |
|     |            |           | 1,85   | 179°04,3' |

|     |            |           |       |           |
|-----|------------|-----------|-------|-----------|
| 344 | 2202261,17 | 422244,2  |       |           |
|     |            |           | 1,84  | 178°45,3' |
| 345 | 2202261,21 | 422242,36 |       |           |
|     |            |           | 1,85  | 179°04,3' |
| 346 | 2202261,24 | 422240,51 |       |           |
|     |            |           | 1,84  | 178°07,9' |
| 347 | 2202261,3  | 422238,67 |       |           |
|     |            |           | 1,85  | 178°08,5' |
| 348 | 2202261,36 | 422236,82 |       |           |
|     |            |           | 1,84  | 177°49,2' |
| 349 | 2202261,43 | 422234,98 |       |           |
|     |            |           | 1,85  | 177°31,5' |
| 350 | 2202261,51 | 422233,13 |       |           |
|     |            |           | 1,85  | 177°12,8' |
| 351 | 2202261,6  | 422231,28 |       |           |
|     |            |           | 1,85  | 176°54,4' |
| 352 | 2202261,7  | 422229,43 |       |           |
|     |            |           | 1,84  | 176°34,7' |
| 353 | 2202261,81 | 422227,59 |       |           |
|     |            |           | 1,84  | 176°16,1' |
| 354 | 2202261,93 | 422225,75 |       |           |
|     |            |           | 1,84  | 175°57,5' |
| 355 | 2202262,06 | 422223,91 |       |           |
|     |            |           | 1,85  | 176°17,3' |
| 356 | 2202262,18 | 422222,06 |       |           |
|     |            |           | 1,85  | 175°20,4' |
| 357 | 2202262,33 | 422220,22 |       |           |
|     |            |           | 1,85  | 175°01,8' |
| 358 | 2202262,49 | 422218,38 |       |           |
|     |            |           | 1,85  | 175°01,8' |
| 359 | 2202262,65 | 422216,54 |       |           |
|     |            |           | 1,86  | 174°26,6' |
| 360 | 2202262,83 | 422214,69 |       |           |
|     |            |           | 1,84  | 174°41,6' |
| 361 | 2202263    | 422212,86 |       |           |
|     |            |           | 1,85  | 174°06,2' |
| 362 | 2202263,19 | 422211,02 |       |           |
|     |            |           | 71,58 | 173°56,2' |
| 363 | 2202270,75 | 422139,84 |       |           |
|     |            |           | 79,11 | 173°56,4' |
| 168 | 2202279,1  | 422061,18 |       |           |
|     |            |           | 35,59 | 83°52,9'  |
| 169 | 2202314,49 | 422064,97 |       |           |

|     |            |           |        |           |
|-----|------------|-----------|--------|-----------|
|     |            |           | 100,99 | 83°53'    |
| 170 | 2202414,9  | 422075,73 |        |           |
|     |            |           | 12     | 83°52,9'  |
| 171 | 2202426,83 | 422077,01 |        |           |
|     |            |           | 12     | 353°52,7' |
| 172 | 2202425,55 | 422088,94 |        |           |
|     |            |           | 11,35  | 353°52,7' |
| 173 | 2202424,34 | 422100,23 |        |           |
|     |            |           | 14,66  | 83°52,9'  |
| 174 | 2202438,92 | 422101,79 |        |           |
|     |            |           | 111,89 | 83°52,9'  |
| 175 | 2202550,17 | 422113,71 |        |           |
|     |            |           | 76,66  | 83°55'    |
| 176 | 2202626,4  | 422121,84 |        |           |
|     |            |           | 73,27  | 353°53,4' |
| 177 | 2202618,6  | 422194,69 |        |           |
|     |            |           | 76,67  | 263°56'   |
| 178 | 2202542,36 | 422186,59 |        |           |
|     |            |           | 8      | 173°51,9' |
| 179 | 2202543,22 | 422178,63 |        |           |
|     |            |           | 30,01  | 263°53,1' |
| 180 | 2202513,38 | 422175,43 |        |           |
|     |            |           | 8,02   | 353°47,4' |
| 181 | 2202512,51 | 422183,41 |        |           |
|     |            |           | 6,98   | 353°47,4' |
| 182 | 2202511,76 | 422190,34 |        |           |
|     |            |           | 113,7  | 83°54,4'  |
| 183 | 2202624,81 | 422202,41 |        |           |
|     |            |           | 68,24  | 173°53,1' |
| 184 | 2202632,08 | 422134,56 |        |           |
|     |            |           | 12,06  | 173°55,3' |
| 185 | 2202633,36 | 422122,57 |        |           |
|     |            |           | 9,22   | 83°52,9'  |
| 186 | 2202642,53 | 422123,55 |        |           |
|     |            |           | 219,73 | 173°38,7' |
| 187 | 2202666,85 | 421905,17 |        |           |
|     |            |           | 6,79   | 120°43,7' |
| 188 | 2202672,69 | 421901,7  |        |           |
|     |            |           | 30     | 120°43,6' |
| 189 | 2202698,47 | 421886,37 |        |           |
|     |            |           | 50     | 30°43,7'  |
| 364 | 2202724,02 | 421929,35 |        |           |
|     |            |           | 194,16 | 30°43,6'  |

|     |            |           |       |          |
|-----|------------|-----------|-------|----------|
| 365 | 2202823,23 | 422096,25 |       |          |
| 319 | 2202834,97 | 422116,01 | 22,99 | 30°43,6' |

Площадь 96 096 кв. м

Контур красной линии 8

| Обозначение<br>характерных точек<br>границ | X, м       | Y, м      | Мера<br>линий, м | Дирек. углы,<br>град мин сек |
|--|------------|-----------|------------------|------------------------------|
| 103  | 2203087,58 | 422534,79 | 11,55            | 276°52,5'                    |
| 104  | 2203076,11 | 422536,17 | 11,7             | 276°20,7'                    |
| 105  | 2203064,48 | 422537,46 | 12,05            | 274°54,9'                    |
| 106  | 2203052,47 | 422538,5  | 11,79            | 273°55,3'                    |
| 107  | 2203040,71 | 422539,3  | 11,57            | 272°10,5'                    |
| 108  | 2203029,14 | 422539,74 | 11,93            | 271°50,6'                    |
| 109  | 2203017,22 | 422540,13 | 11,64            | 270°23,3'                    |
| 110  | 2203005,58 | 422540,21 | 11,67            | 269°16,6'                    |
| 111  | 2202993,91 | 422540,06 | 11,76            | 268°09,2'                    |
| 112  | 2202982,16 | 422539,68 | 11,58            | 266°31,8'                    |
| 113  | 2202970,59 | 422538,98 | 11,69            | 265°50,3'                    |
| 114  | 2202958,94 | 422538,13 | 12               | 265°21,5'                    |
| 115  | 2202946,98 | 422537,16 | 55,31            | 264°16,9'                    |

|     |            |           |        |           |
|-----|------------|-----------|--------|-----------|
| 116 | 2202891,94 | 422531,65 |        |           |
|     |            |           | 12     | 264°16,9' |
| 117 | 2202880    | 422530,45 |        |           |
|     |            |           | 10,08  | 174°16,9' |
| 372 | 2202881    | 422520,42 |        |           |
|     |            |           | 122,56 | 264°14,3' |
| 373 | 2202759,06 | 422508,11 |        |           |
|     |            |           | 19,97  | 264°14,3' |
| 374 | 2202739,19 | 422506,11 |        |           |
|     |            |           | 16,88  | 196°60'   |
| 375 | 2202734,25 | 422489,97 |        |           |
|     |            |           | 93,86  | 196°60'   |
| 376 | 2202706,81 | 422400,2  |        |           |
|     |            |           | 149,79 | 196°59,9' |
| 377 | 2202663,02 | 422256,96 |        |           |
|     |            |           | 16,56  | 107°02'   |
| 378 | 2202678,85 | 422252,11 |        |           |
|     |            |           | 5,32   | 107°30,9' |
| 379 | 2202683,92 | 422250,51 |        |           |
|     |            |           | 10     | 109°16,1' |
| 380 | 2202693,36 | 422247,21 |        |           |
|     |            |           | 10,01  | 111°12,4' |
| 381 | 2202702,69 | 422243,59 |        |           |
|     |            |           | 9,97   | 113°26,4' |
| 382 | 2202711,83 | 422239,63 |        |           |
|     |            |           | 10,03  | 115°28,8' |
| 383 | 2202720,89 | 422235,31 |        |           |
|     |            |           | 10     | 117°30,8' |
| 384 | 2202729,76 | 422230,69 |        |           |
|     |            |           | 10     | 119°44,7' |
| 385 | 2202738,44 | 422225,73 |        |           |
|     |            |           | 143,89 | 120°43,9' |
| 99  | 2202862,12 | 422152,2  |        |           |
|     |            |           | 133,75 | 30°46,7'  |
| 100 | 2202930,56 | 422267,11 |        |           |
|     |            |           | 123,98 | 30°43,1'  |
| 101 | 2202993,89 | 422373,69 |        |           |
|     |            |           | 176,22 | 30°43,1'  |

|     |            |           |       |          |
|-----|------------|-----------|-------|----------|
| 102 | 2203083,91 | 422525,19 |       |          |
| 103 | 2203087,58 | 422534,79 | 10,28 | 20°53,1' |

Площадь 94 059 кв. м

### Контур красной линии 9

| Обозначение<br>характерных точек<br>границ | X, м       | Y, м      | Мера<br>линий, м | Дирек. углы,<br>град мин сек |
|--|------------|-----------|------------------|------------------------------|
| 249  | 2202801,43 | 421513,29 | 132,97           | 353°38,3'                    |
| 250  | 2202786,7  | 421645,44 | 111,49           | 263°35'                      |
| 251  | 2202675,9  | 421632,98 | 37,3             | 263°35,2'                    |
| 252  | 2202638,84 | 421628,82 | 172,08           | 353°35'                      |
| 240  | 2202619,61 | 421799,82 | 124,71           | 263°35,2'                    |
| 301  | 2202495,68 | 421785,89 | 12               | 263°35,2'                    |
| 302  | 2202483,76 | 421784,55 | 174,3            | 263°35,2'                    |
| 303  | 2202310,55 | 421765,08 | 183,39           | 173°56,2'                    |
| 304  | 2202329,92 | 421582,72 | 73,46            | 173°56,2'                    |
| 305  | 2202337,68 | 421509,67 | 17,8             | 83°38,7'                     |
| 306  | 2202355,37 | 421511,64 | 3,06             | 176°26,1'                    |
| 307  | 2202355,56 | 421508,59 | 32,61            | 172°34,9'                    |
| 308  | 2202359,77 | 421476,25 | 12               | 172°34,9'                    |
| 309  | 2202361,32 | 421464,35 | 12               | 83°39,3'                     |
| 310  | 2202373,25 | 421465,68 |                  |                              |

|     |            |           |        |          |
|-----|------------|-----------|--------|----------|
|     |            |           | 319,33 | 83°39,3' |
| 311 | 2202690,62 | 421500,97 |        |          |
| 249 | 2202801,43 | 421513,29 | 111,5  | 83°39,3' |

Площадь 113 941 кв. м

Контур красной линии 10

| Обозначение<br>характерных точек<br>границ | X, м       | Y, м      | Мера<br>линий, м | Дирек. углы,<br>град мин сек |
|--|------------|-----------|------------------|------------------------------|
| 239  | 2202762,71 | 421945,55 | 50,79            | 120°40,5'                    |
| 238  | 2202806,39 | 421919,64 | 98,26            | 120°40,5'                    |
| 237  | 2202890,9  | 421869,51 | 102,79           | 210°44,2'                    |
| 236  | 2202838,37 | 421781,16 | 15               | 300°44,2'                    |
| 235  | 2202825,47 | 421788,82 | 15               | 210°44,2'                    |
| 234  | 2202817,81 | 421775,93 | 15,09            | 120°44,2'                    |
| 233  | 2202830,78 | 421768,22 | 70,2             | 210°39,8'                    |
| 232  | 2202794,98 | 421707,84 | 132,1            | 120°36,9'                    |
| 231  | 2202908,66 | 421640,57 | 72,4             | 120°36,9'                    |
| 230  | 2202970,97 | 421603,7  | 6,53             | 216°51,4'                    |
| 253  | 2202967,05 | 421598,47 | 8,65             | 219°28'                      |
| 254  | 2202961,55 | 421591,79 | 8,67             | 221°57,8'                    |
| 255  | 2202955,75 | 421585,34 | 8,69             | 224°18'                      |
| 256  | 2202949,68 | 421579,12 | 8,7              | 226°40,6'                    |
| 257  | 2202943,35 | 421573,15 |                  |                              |

|     |            |           |        |           |
|-----|------------|-----------|--------|-----------|
|     |            |           | 8,69   | 229°06,3' |
| 258 | 2202936,78 | 421567,46 | 8,71   | 231°26'   |
| 259 | 2202929,97 | 421562,03 | 8,71   | 233°41'   |
| 260 | 2202922,95 | 421556,87 | 8,7    | 235°57,8' |
| 261 | 2202915,74 | 421552    | 8,69   | 238°16'   |
| 262 | 2202908,35 | 421547,43 | 8,66   | 240°37,5' |
| 263 | 2202900,8  | 421543,18 | 8,65   | 242°48,8' |
| 264 | 2202893,11 | 421539,23 | 8,65   | 245°02,1' |
| 265 | 2202885,27 | 421535,58 | 8,64   | 247°06,9' |
| 266 | 2202877,31 | 421532,22 | 8,63   | 249°01,5' |
| 267 | 2202869,25 | 421529,13 | 8,63   | 250°56,1' |
| 268 | 2202861,09 | 421526,31 | 8,64   | 252°45,6' |
| 269 | 2202852,84 | 421523,75 | 8,66   | 254°19,6' |
| 270 | 2202844,5  | 421521,41 | 8,64   | 255°59,8' |
| 271 | 2202836,12 | 421519,32 | 8,64   | 257°30,4' |
| 272 | 2202827,68 | 421517,45 | 8,63   | 258°54,7' |
| 273 | 2202819,21 | 421515,79 | 2,95   | 260°13,1' |
| 274 | 2202816,3  | 421515,29 | 71,82  | 353°38,3' |
| 246 | 2202808,34 | 421586,66 | 77,43  | 353°35'   |
| 245 | 2202799,69 | 421663,61 | 147,23 | 263°35'   |
| 244 | 2202653,38 | 421647,15 | 135,15 | 353°34,6' |
| 243 | 2202638,26 | 421781,45 | 12     | 353°39,3' |

|     |            |           |       |           |
|-----|------------|-----------|-------|-----------|
| 242 | 2202636,94 | 421793,38 |       |           |
|     |            |           | 8,33  | 353°35,3' |
| 241 | 2202636,01 | 421801,66 |       |           |
|     |            |           | 24,98 | 83°35,2'  |
| 275 | 2202660,83 | 421804,45 |       |           |
|     |            |           | 1,12  | 80°47,3'  |
| 276 | 2202661,94 | 421804,63 |       |           |
|     |            |           | 1,61  | 80°00,8'  |
| 277 | 2202663,53 | 421804,91 |       |           |
|     |            |           | 1,64  | 78°25'    |
| 278 | 2202665,14 | 421805,24 |       |           |
|     |            |           | 1,63  | 76°08,1'  |
| 279 | 2202666,72 | 421805,63 |       |           |
|     |            |           | 1,63  | 74°00,4'  |
| 280 | 2202668,29 | 421806,08 |       |           |
|     |            |           | 1,63  | 72°53,8'  |
| 281 | 2202669,85 | 421806,56 |       |           |
|     |            |           | 1,63  | 69°53,8'  |
| 282 | 2202671,38 | 421807,12 |       |           |
|     |            |           | 1,61  | 67°24,4'  |
| 283 | 2202672,87 | 421807,74 |       |           |
|     |            |           | 1,62  | 65°10,5'  |
| 284 | 2202674,34 | 421808,42 |       |           |
|     |            |           | 1,63  | 62°39'    |
| 285 | 2202675,79 | 421809,17 |       |           |
|     |            |           | 1,61  | 59°46,2'  |
| 286 | 2202677,18 | 421809,98 |       |           |
|     |            |           | 1,62  | 56°36,3'  |
| 287 | 2202678,53 | 421810,87 |       |           |
|     |            |           | 1,61  | 53°50,5'  |
| 288 | 2202679,83 | 421811,82 |       |           |
|     |            |           | 1,61  | 51°17,1'  |
| 289 | 2202681,09 | 421812,83 |       |           |
|     |            |           | 1,62  | 48°14,9'  |
| 290 | 2202682,3  | 421813,91 |       |           |
|     |            |           | 1,63  | 46°29,7'  |
| 291 | 2202683,48 | 421815,03 |       |           |
|     |            |           | 1,63  | 44°00,2'  |
| 292 | 2202684,61 | 421816,2  |       |           |
|     |            |           | 1,64  | 41°32,8'  |
| 293 | 2202685,7  | 421817,43 |       |           |
|     |            |           | 1,63  | 38°46,2'  |
| 294 | 2202686,72 | 421818,7  |       |           |

|     |            |           |        |          |
|-----|------------|-----------|--------|----------|
|     |            |           | 1,63   | 38°46,2' |
| 295 | 2202687,74 | 421819,97 | 1,64   | 35°49,3' |
| 296 | 2202688,7  | 421821,3  | 1,61   | 34°22,8' |
| 297 | 2202689,61 | 421822,63 | 143,02 | 30°44,3' |
| 239 | 2202762,71 | 421945,55 |        |          |

Площадь 61 050 кв. м

---

### Контур красной линии 11

| Обозначение<br>характерных точек<br>границ | X, м       | Y, м      | Мера<br>линий, м | Дирек. углы,<br>град мин сек |
|--|------------|-----------|------------------|------------------------------|
| 298  | 2203161,23 | 421922    | 170,07           | 300°44,2'                    |
| 299  | 2203015,05 | 422008,92 | 184,5            | 300°44,2'                    |
| 300  | 2202856,47 | 422103,22 | 168,44           | 210°44,3'                    |
| 222  | 2202770,38 | 421958,45 | 18,92            | 120°40,5'                    |
| 223  | 2202786,64 | 421948,8  | 12               | 120°40,5'                    |
| 224  | 2202796,97 | 421942,67 | 153,77           | 120°40,5'                    |
| 225  | 2202929,22 | 421864,23 | 12               | 120°40,5'                    |
| 226  | 2202939,54 | 421858,1  | 157,86           | 120°40,5'                    |
| 227  | 2203075,31 | 421777,57 | 168,06           | 30°44,9'                     |
| 298  | 2203161,23 | 421922    |                  |                              |

Площадь 59 653 кв. м

## Контур красной линии 12

| Обозначение<br>характерных точек<br>границ | X, м       | Y, м      | Мера<br>линий, м | Дирек. углы,<br>град мин сек |
|--|------------|-----------|------------------|------------------------------|
| 99   | 2202862,12 | 422152,2  | 133,75           | 30°46,7'                     |
| 100  | 2202930,56 | 422267,11 |                  | 123,98                       |
| 101  | 2202993,89 | 422373,69 | 176,22           | 30°43,1'                     |
| 102  | 2203083,91 | 422525,19 | 10,28            | 20°53,1'                     |
| 103  | 2203087,58 | 422534,79 | 11,55            | 276°52,5'                    |
| 104  | 2203076,11 | 422536,17 | 11,7             | 276°20,7'                    |
| 105  | 2203064,48 | 422537,46 | 12,05            | 274°54,9'                    |
| 106  | 2203052,47 | 422538,5  | 11,79            | 273°55,3'                    |
| 107  | 2203040,71 | 422539,3  | 11,57            | 272°10,5'                    |
| 108  | 2203029,14 | 422539,74 | 11,93            | 271°50,6'                    |
| 109  | 2203017,22 | 422540,13 | 11,64            | 270°23,3'                    |
| 110  | 2203005,58 | 422540,21 | 11,67            | 269°16,6'                    |
| 111  | 2202993,91 | 422540,06 | 11,76            | 268°09,2'                    |
| 112  | 2202982,16 | 422539,68 | 11,58            | 266°31,8'                    |
| 113  | 2202970,59 | 422538,98 | 11,69            | 265°50,3'                    |
| 114  | 2202958,94 | 422538,13 | 12               | 265°21,5'                    |
| 115  | 2202946,98 | 422537,16 | 55,31            | 264°16,9'                    |
| 116  | 2202891,94 | 422531,65 | 12               | 264°16,9'                    |
| 117  | 2202880    | 422530,45 | 14,9             | 354°14,9'                    |
| 45   | 2202878,5  | 422545,28 |                  |                              |

|    |            |           |       |           |
|----|------------|-----------|-------|-----------|
|    |            |           | 67,59 | 84°12,1'  |
| 46 | 2202945,74 | 422552,11 | 12,02 | 85°21,5'  |
| 47 | 2202957,72 | 422553,08 | 12    | 85°50,5'  |
| 48 | 2202969,69 | 422553,95 | 11,99 | 86°33,4'  |
| 49 | 2202981,66 | 422554,67 | 11,77 | 88°09,1'  |
| 50 | 2202993,42 | 422555,05 | 12,24 | 89°16,6'  |
| 51 | 2203005,67 | 422555,21 | 12,05 | 90°24,7'  |
| 52 | 2203017,71 | 422555,12 | 12,02 | 91°50,7'  |
| 53 | 2203029,72 | 422554,73 | 12,03 | 92°12,5'  |
| 54 | 2203041,74 | 422554,27 | 12,07 | 93°56,1'  |
| 55 | 2203053,78 | 422553,44 | 12,05 | 94°55'    |
| 56 | 2203065,78 | 422552,41 | 12,06 | 96°19,4'  |
| 57 | 2203077,76 | 422551,08 | 12,08 | 96°53,6'  |
| 58 | 2203089,76 | 422549,63 | 12,09 | 98°18,2'  |
| 59 | 2203101,72 | 422547,88 | 12,1  | 99°26,1'  |
| 60 | 2203113,66 | 422545,9  | 12,12 | 100°34'   |
| 61 | 2203125,57 | 422543,68 | 12,12 | 101°42,1' |
| 62 | 2203137,44 | 422541,22 | 12,18 | 102°50,2' |
| 63 | 2203149,31 | 422538,51 | 10,15 | 103°53,1' |
| 64 | 2203159,16 | 422536,08 | 12,17 | 103°55,7' |
| 65 | 2203170,97 | 422533,15 | 12,22 | 106°41,6' |
| 66 | 2203182,68 | 422529,64 | 12,28 | 107°34,5' |

|     |            |           |       |           |
|-----|------------|-----------|-------|-----------|
| 67  | 2203194,39 | 422525,93 |       |           |
|     |            |           | 12,26 | 107°34,6' |
| 68  | 2203206,08 | 422522,23 |       |           |
|     |            |           | 12,26 | 107°34,6' |
| 69  | 2203217,77 | 422518,52 |       |           |
|     |            |           | 12,26 | 107°34,6' |
| 70  | 2203229,46 | 422514,82 |       |           |
|     |            |           | 12,25 | 107°34,7' |
| 71  | 2203241,14 | 422511,12 |       |           |
|     |            |           | 12,04 | 109°26,5' |
| 1   | 2203252,49 | 422507,11 |       |           |
|     |            |           | 21,19 | 115°53,2' |
| 118 | 2203271,56 | 422497,86 |       |           |
|     |            |           | 63,49 | 117°49,7' |
| 119 | 2203327,71 | 422468,22 |       |           |
|     |            |           | 63,5  | 119°45'   |
| 120 | 2203382,84 | 422436,71 |       |           |
|     |            |           | 63,49 | 121°40,6' |
| 121 | 2203436,87 | 422403,37 |       |           |
|     |            |           | 10,75 | 123°37,3' |
| 122 | 2203445,82 | 422397,42 |       |           |
|     |            |           | 15,01 | 213°36,3' |
| 123 | 2203437,52 | 422384,92 |       |           |
|     |            |           | 10,8  | 303°36,9' |
| 124 | 2203428,52 | 422390,9  |       |           |
|     |            |           | 62,99 | 301°40,8' |
| 125 | 2203374,91 | 422423,98 |       |           |
|     |            |           | 25,83 | 299°44,1' |
| 126 | 2203352,49 | 422436,79 |       |           |
|     |            |           | 37,16 | 299°44,1' |
| 127 | 2203320,22 | 422455,22 |       |           |
|     |            |           | 62,98 | 297°49'   |
| 128 | 2203264,52 | 422484,61 |       |           |
|     |            |           | 20,65 | 295°52,1' |
| 129 | 2203245,93 | 422493,62 |       |           |
|     |            |           | 10,09 | 288°54,2' |
| 130 | 2203236,38 | 422496,89 |       |           |
|     |            |           | 12,02 | 287°34,6' |
| 131 | 2203224,93 | 422500,52 |       |           |
|     |            |           | 12,2  | 286°38,7' |
| 132 | 2203213,24 | 422504,02 |       |           |
|     |            |           | 12,33 | 288°29,9' |
| 133 | 2203201,55 | 422507,93 |       |           |

|     |            |           |        |           |
|-----|------------|-----------|--------|-----------|
|     |            |           | 12,26  | 288°29,9' |
| 134 | 2203189,92 | 422511,82 | 12,27  | 286°39,3' |
| 135 | 2203178,17 | 422515,33 | 12,02  | 286°41,1' |
| 136 | 2203166,66 | 422518,78 | 11,43  | 283°50,5' |
| 137 | 2203155,56 | 422521,52 | 10,01  | 283°52,9' |
| 138 | 2203145,84 | 422523,92 | 12,02  | 282°50,3' |
| 139 | 2203134,12 | 422526,59 | 11,84  | 281°41,3' |
| 140 | 2203122,52 | 422528,99 | 11,84  | 280°33,2' |
| 141 | 2203110,89 | 422531,16 | 13,7   | 232°38,5' |
| 142 | 2203100    | 422522,84 | 198,46 | 210°44,2' |
| 143 | 2202998,57 | 422352,27 | 130,51 | 120°44,6' |
| 144 | 2203110,74 | 422285,55 | 130,51 | 120°44,6' |
| 145 | 2203222,9  | 422218,83 | 98,63  | 120°44,6' |
| 146 | 2203307,67 | 422168,41 | 15,03  | 210°44'   |
| 147 | 2203299,99 | 422155,49 | 98,63  | 300°44,6' |
| 148 | 2203215,22 | 422205,91 | 90,68  | 300°44,6' |
| 149 | 2203137,28 | 422252,27 | 158,29 | 300°44,6' |
| 150 | 2203001,24 | 422333,19 | 12     | 300°44,6' |
| 151 | 2202990,92 | 422339,32 | 12     | 210°44,9' |
| 152 | 2202984,79 | 422329,01 | 105,63 | 210°44,7' |
| 153 | 2202930,79 | 422238,23 | 109,04 | 210°45,1' |
| 154 | 2202875,04 | 422144,52 | 15,02  | 300°43,9' |

|    |            |          |  |  |
|----|------------|----------|--|--|
| 99 | 2202862,12 | 422152,2 |  |  |
|----|------------|----------|--|--|

Площадь 21 118 кв. м

Контур красной линии 13

| Обозначение<br>характерных точек<br>границ | X, м       | Y, м      | Мера<br>линий, м | Дирек. углы,<br>град мин сек |
|--|------------|-----------|------------------|------------------------------|
| 155  | 2203467,61 | 422364,92 | 15,01            | 31°15,7'                     |
| 156  | 2203475,4  | 422377,75 | 17,23            | 123°35,3'                    |
| 157  | 2203489,75 | 422368,22 | 98,28            | 121°49,7'                    |
| 158  | 2203573,25 | 422316,39 | 91,25            | 125°56,4'                    |
| 159  | 2203647,13 | 422262,83 | 357,98           | 125°56,6'                    |
| 160  | 2203936,95 | 422052,7  | 15,21            | 206°10,7'                    |
| 161  | 2203930,24 | 422039,05 | 159,22           | 305°56,3'                    |
| 162  | 2203801,33 | 422132,5  | 85,75            | 305°56,5'                    |
| 163  | 2203731,91 | 422182,83 | 12               | 305°56,5'                    |
| 164  | 2203722,19 | 422189,87 | 103,65           | 305°56,5'                    |
| 165  | 2203638,27 | 422250,71 | 90,72            | 305°56,6'                    |
| 166  | 2203564,83 | 422303,96 | 98,2             | 301°50'                      |
| 167  | 2203481,4  | 422355,76 | 16,56            | 303°35,5'                    |
| 155  | 2203467,61 | 422364,92 |                  |                              |

Площадь 8 483 кв. м

## Контур красной линии 14

| Обозначение<br>характерных точек<br>границ | X, м       | Y, м      | Мера<br>линий, м | Дирек. углы,<br>град мин сек |
|--|------------|-----------|------------------|------------------------------|
| 168  | 2202279,1  | 422061,18 | 35,59            | 83°52,9'                     |
| 169  | 2202314,49 | 422064,97 | 100,99           | 83°53'                       |
| 170  | 2202414,9  | 422075,73 | 12               | 83°52,9'                     |
| 171  | 2202426,83 | 422077,01 | 12               | 353°52,7'                    |
| 172  | 2202425,55 | 422088,94 | 11,35            | 353°52,7'                    |
| 173  | 2202424,34 | 422100,23 | 14,66            | 83°52,9'                     |
| 174  | 2202438,92 | 422101,79 | 111,89           | 83°52,9'                     |
| 175  | 2202550,17 | 422113,71 | 76,66            | 83°55'                       |
| 176  | 2202626,4  | 422121,84 | 73,27            | 353°53,4'                    |
| 177  | 2202618,6  | 422194,69 | 76,67            | 263°56'                      |
| 178  | 2202542,36 | 422186,59 | 8                | 173°51,9'                    |
| 179  | 2202543,22 | 422178,63 | 30,01            | 263°53,1'                    |
| 180  | 2202513,38 | 422175,43 | 8,02             | 353°47,4'                    |
| 181  | 2202512,51 | 422183,41 | 6,98             | 353°47,4'                    |
| 182  | 2202511,76 | 422190,34 | 113,7            | 83°54,4'                     |
| 183  | 2202624,81 | 422202,41 | 68,24            | 173°53,1'                    |
| 184  | 2202632,08 | 422134,56 | 12,06            | 173°55,3'                    |
| 185  | 2202633,36 | 422122,57 | 9,22             | 83°52,9'                     |
| 186  | 2202642,53 | 422123,55 | 219,73           | 173°38,7'                    |
| 187  | 2202666,85 | 421905,17 |                  |                              |

|     |            |           |       |           |
|-----|------------|-----------|-------|-----------|
|     |            |           | 6,79  | 120°43,7' |
| 188 | 2202672,69 | 421901,7  | 30    | 120°43,6' |
| 189 | 2202698,47 | 421886,37 | 59,07 | 210°43,5' |
| 190 | 2202668,29 | 421835,59 | 0,71  | 215°15,4' |
| 191 | 2202667,88 | 421835,01 | 0,72  | 215°54,6' |
| 192 | 2202667,46 | 421834,43 | 0,72  | 219°24'   |
| 193 | 2202667    | 421833,87 | 0,72  | 222°10'   |
| 194 | 2202666,52 | 421833,34 | 0,73  | 223°19,9' |
| 195 | 2202666,02 | 421832,81 | 0,7   | 226°44,1' |
| 196 | 2202665,51 | 421832,33 | 0,71  | 230°42,6' |
| 197 | 2202664,96 | 421831,88 | 0,72  | 234°05,4' |
| 198 | 2202664,38 | 421831,46 | 0,7   | 237°12,9' |
| 199 | 2202663,79 | 421831,08 | 0,71  | 241°15,6' |
| 200 | 2202663,17 | 421830,74 | 0,71  | 244°53,1' |
| 201 | 2202662,53 | 421830,44 | 0,72  | 248°47,4' |
| 202 | 2202661,86 | 421830,18 | 0,72  | 251°18,8' |
| 203 | 2202661,18 | 421829,95 | 0,71  | 253°36,6' |
| 204 | 2202660,5  | 421829,75 | 0,72  | 255°34,8' |
| 205 | 2202659,8  | 421829,57 | 0,71  | 258°41,4' |
| 206 | 2202659,1  | 421829,43 | 0,72  | 259°37,5' |
| 207 | 2202658,39 | 421829,3  | 13,83 | 263°35,6' |
| 208 | 2202644,64 | 421827,76 | 58,58 | 353°35,2' |

|     |            |           |        |           |
|-----|------------|-----------|--------|-----------|
| 209 | 2202638,1  | 421885,97 |        |           |
|     |            |           | 15,06  | 353°36,4' |
| 210 | 2202636,42 | 421900,94 |        |           |
|     |            |           | 15,72  | 83°52,9'  |
| 211 | 2202652,05 | 421902,61 |        |           |
|     |            |           | 30,65  | 353°52,9' |
| 212 | 2202648,78 | 421933,09 |        |           |
|     |            |           | 12     | 353°52,9' |
| 213 | 2202647,5  | 421945,02 |        |           |
|     |            |           | 162,1  | 353°52,9' |
| 214 | 2202630,23 | 422106,2  |        |           |
|     |            |           | 190,35 | 263°52,9' |
| 215 | 2202440,96 | 422085,91 |        |           |
|     |            |           | 22,35  | 173°50,7' |
| 216 | 2202443,36 | 422063,7  |        |           |
|     |            |           | 163,61 | 263°52,9' |
| 217 | 2202280,69 | 422046,26 |        |           |
|     |            |           | 15     | 353°56,3' |
| 168 | 2202279,1  | 422061,18 |        |           |

Площадь 13 682 кв. м

---

Контур красной линии 15

| Обозначение<br>характерных точек<br>границ | X, м       | Y, м      | Мера<br>линий, м | Дирек. углы,<br>град мин сек |
|--|------------|-----------|------------------|------------------------------|
| 240  | 2202619,61 | 421799,82 | 16,5             | 83°35,3'                     |
| 241  | 2202636,01 | 421801,66 | 8,33             | 173°35,3'                    |
| 242  | 2202636,94 | 421793,38 | 12               | 173°39,3'                    |
| 243  | 2202638,26 | 421781,45 | 135,15           | 173°34,6'                    |
| 244  | 2202653,38 | 421647,15 | 147,23           | 83°35'                       |
| 245  | 2202799,69 | 421663,61 | 77,43            | 173°35'                      |
| 246  | 2202808,34 | 421586,66 | 71,82            | 173°38,3'                    |

|     |            |           |        |           |
|-----|------------|-----------|--------|-----------|
| 247 | 2202816,3  | 421515,29 |        |           |
|     |            |           | 5,67   | 260°11,3' |
| 248 | 2202810,71 | 421514,32 |        |           |
|     |            |           | 9,34   | 263°39,3' |
| 249 | 2202801,43 | 421513,29 |        |           |
|     |            |           | 132,97 | 353°38,3' |
| 250 | 2202786,7  | 421645,44 |        |           |
|     |            |           | 111,49 | 263°35'   |
| 251 | 2202675,9  | 421632,98 |        |           |
|     |            |           | 37,3   | 263°35,2' |
| 252 | 2202638,84 | 421628,82 |        |           |
|     |            |           | 172,08 | 353°35'   |
| 240 | 2202619,61 | 421799,82 |        |           |

Площадь 7 274 кв. м

Контур красной линии 16

| Обозначение<br>характерных точек<br>границ | X, м       | Y, м      | Мера<br>линий, м | Дирек. углы,<br>град мин сек |
|--|------------|-----------|------------------|------------------------------|
| 222  | 2202770,38 | 421958,45 | 18,92            | 120°40,5'                    |
| 223  | 2202786,64 | 421948,8  | 12               | 120°40,5'                    |
| 224  | 2202796,97 | 421942,67 | 153,77           | 120°40,5'                    |
| 225  | 2202929,22 | 421864,23 | 12               | 120°40,5'                    |
| 226  | 2202939,54 | 421858,1  | 157,86           | 120°40,5'                    |
| 227  | 2203075,31 | 421777,57 | 15               | 210°44,9'                    |
| 220  | 2203067,64 | 421764,68 | 190,49           | 300°40,5'                    |
| 219  | 2202903,8  | 421861,86 | 171,96           | 210°44,2'                    |
| 218  | 2202815,92 | 421714,05 | 190,45           | 120°36,8'                    |
| 221  | 2202979,82 | 421617,07 | 5,32             | 210°44,9'                    |

|     |            |           |        |           |
|-----|------------|-----------|--------|-----------|
| 228 | 2202977,1  | 421612,49 |        |           |
|     |            |           | 8,62   | 214°24,6' |
| 229 | 2202972,23 | 421605,38 |        |           |
|     |            |           | 2,1    | 216°51,4' |
| 230 | 2202970,97 | 421603,7  |        |           |
|     |            |           | 72,4   | 300°36,9' |
| 231 | 2202908,66 | 421640,57 |        |           |
|     |            |           | 132,1  | 300°36,9' |
| 232 | 2202794,98 | 421707,84 |        |           |
|     |            |           | 70,2   | 30°39,8'  |
| 233 | 2202830,78 | 421768,22 |        |           |
|     |            |           | 15,09  | 300°44,2' |
| 234 | 2202817,81 | 421775,93 |        |           |
|     |            |           | 15     | 30°44,2'  |
| 235 | 2202825,47 | 421788,82 |        |           |
|     |            |           | 15     | 120°44,2' |
| 236 | 2202838,37 | 421781,16 |        |           |
|     |            |           | 102,79 | 30°44,2'  |
| 237 | 2202890,9  | 421869,51 |        |           |
|     |            |           | 98,26  | 300°40,5' |
| 238 | 2202806,39 | 421919,64 |        |           |
|     |            |           | 50,79  | 300°40,5' |
| 239 | 2202762,71 | 421945,55 |        |           |
|     |            |           | 15     | 30°44,3'  |
| 222 | 2202770,38 | 421958,45 |        |           |

Площадь 11 399 кв. м

---

Контур красной линии 17

| Обозначение<br>характерных точек<br>границ | X, м       | Y, м      | Мера<br>линий, м | Дирек. углы,<br>град мин сек |
|--|------------|-----------|------------------|------------------------------|
| 218  | 2202815,92 | 421714,05 | 171,96           | 30°44,2'                     |
| 219  | 2202903,8  | 421861,86 | 190,49           | 120°40,5'                    |
| 220  | 2203067,64 | 421764,68 | 171,76           | 210°44,9'                    |
| 221  | 2202979,82 | 421617,07 | 190,45           | 300°36,8'                    |

|     |            |           |  |  |
|-----|------------|-----------|--|--|
| 218 | 2202815,92 | 421714,05 |  |  |
|-----|------------|-----------|--|--|

Площадь 32 734 кв. м

### Контур красной линии 18

| Обозначение<br>характерных точек<br>границ | X, м       | Y, м      | Мера<br>линий, м | Дирек. углы,<br>град мин сек |
|--|------------|-----------|------------------|------------------------------|
| 38   | 2202587,6  | 422559,41 | 13,01            | 252°55,3'                    |
| 72   | 2202575,17 | 422555,59 | 12,57            | 256°05,6'                    |
| 73   | 2202562,97 | 422552,57 | 10,85            | 259°03,2'                    |
| 74   | 2202552,32 | 422550,51 | 11,84            | 261°35,8'                    |
| 75   | 2202540,61 | 422548,78 | 11,27            | 263°56,4'                    |
| 76   | 2202529,4  | 422547,59 | 13,62            | 354°16,1'                    |
| 77   | 2202528,04 | 422561,14 | 9,24             | 245°17,7'                    |
| 78   | 2202519,65 | 422557,28 | 15,59            | 250°26,3'                    |
| 79   | 2202504,96 | 422552,06 | 13,26            | 255°35,2'                    |
| 80   | 2202492,12 | 422548,76 | 14,1             | 261°40,8'                    |
| 81   | 2202478,17 | 422546,72 | 11,33            | 266°42,6'                    |
| 82   | 2202466,86 | 422546,07 | 19,94            | 270°58,6'                    |
| 83   | 2202446,92 | 422546,41 | 54,47            | 273°30,3'                    |
| 84   | 2202392,55 | 422549,74 | 7,13             | 262°30,4'                    |
| 85   | 2202385,48 | 422548,81 | 9,83             | 273°50,9'                    |
| 86   | 2202375,67 | 422549,47 | 17,66            | 267°43,7'                    |

|    |            |           |        |           |
|----|------------|-----------|--------|-----------|
| 87 | 2202358,02 | 422548,77 |        |           |
|    |            |           | 1,57   | 240°09,9' |
| 88 | 2202356,66 | 422547,99 |        |           |
|    |            |           | 8,23   | 241°22,7' |
| 89 | 2202349,44 | 422544,05 |        |           |
|    |            |           | 3,53   | 252°20,1' |
| 90 | 2202346,08 | 422542,98 |        |           |
|    |            |           | 10,04  | 259°47,3' |
| 91 | 2202336,2  | 422541,2  |        |           |
|    |            |           | 13,15  | 231°04,9' |
| 92 | 2202325,97 | 422532,94 |        |           |
|    |            |           | 4,11   | 232°58,9' |
| 93 | 2202322,69 | 422530,46 |        |           |
|    |            |           | 29,19  | 208°35,2' |
| 94 | 2202308,72 | 422504,84 |        |           |
|    |            |           | 11,56  | 203°42,4' |
| 95 | 2202304,07 | 422494,25 |        |           |
|    |            |           | 12,54  | 206°27,1' |
| 96 | 2202298,48 | 422483,02 |        |           |
|    |            |           | 6,3    | 224°39,5' |
| 97 | 2202294,06 | 422478,54 |        |           |
|    |            |           | 12,86  | 200°41,5' |
| 98 | 2202289,51 | 422466,51 |        |           |
|    |            |           | 312,23 | 72°41,4'  |
| 38 | 2202587,6  | 422559,41 |        |           |